

# ATTACHMENT B

## PROJECT DESCRIPTION

TWO NEW BATTING CAGES  
ADJACENT TO VICTORY PARK BASEBALL DIAMOND #2

## SHEET INDEX

G-0.0 GENERAL INFORMATION / COVER SHEET  
A-1.0 PROPOSED PLAN  
A-2.0 BATTING CAGE SECTIONS  
A-3.0 BATTING CAGE DETAILS

## PROJECT DIRECTORY

**CONTRACTOR**  
PEARSON MANAGEMENT SERVICES  
115 W. CALIFORNIA BLVD. #119  
PASADENA, CA 91105  
D.L.E@PEARSONMANAGEMENT.COM



OVERALL SITE PLAN  
SCALE: NOT TO SCALE



**G-0.0**

DATE: 11/14/20  
DRAWN BY: JLM  
CHECKED BY: JLM  
SCALE: AS NOTED

VICTORY PARK  
2575 PALOMA ST.  
PASADENA, CA 91107

### DESCRIPTION

GENERAL INFORMATION  
/ COVER SHEET



Office  
1111 E. WALNUT STREET  
PASADENA, CA 91105  
(626) 304-9564  
Mailing Address:  
115 W. CALIFORNIA BLVD. PMB #139  
PASADENA, CA 91105



1 PROPOSED BATTING CAGE LOCATION - AREA #3  
SCALE 8"=10'

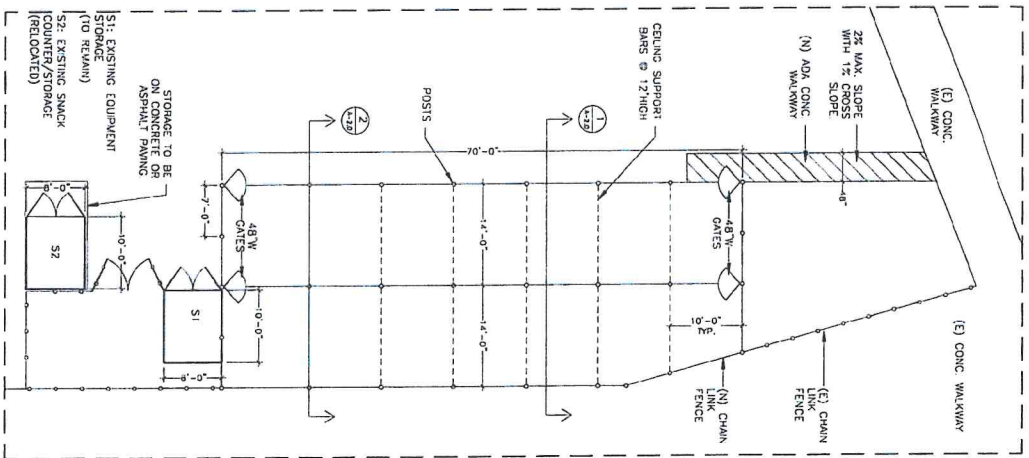
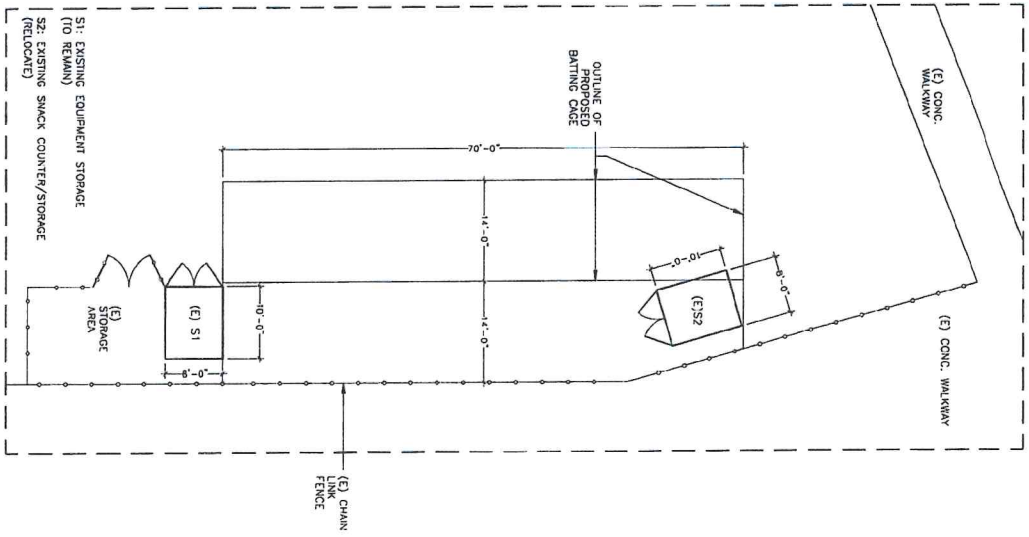

REV. PROPOSED  
DATE: 01/10/17  
SCALE AS NOTED  
SHEET NO.  
**A-1.0**

VICTORY PARK  
2575 PALOMA ST.  
PASADENA, CA 91107

DESCRIPTION  
PROPOSED PLANS



Office  
1111 E. WALNUT STREET  
PASADENA, CA 91106  
(626) 304-9564  
Mailing Address  
115 W. CALIFORNIA BLVD. PMB #139  
PASADENA, CA 91105

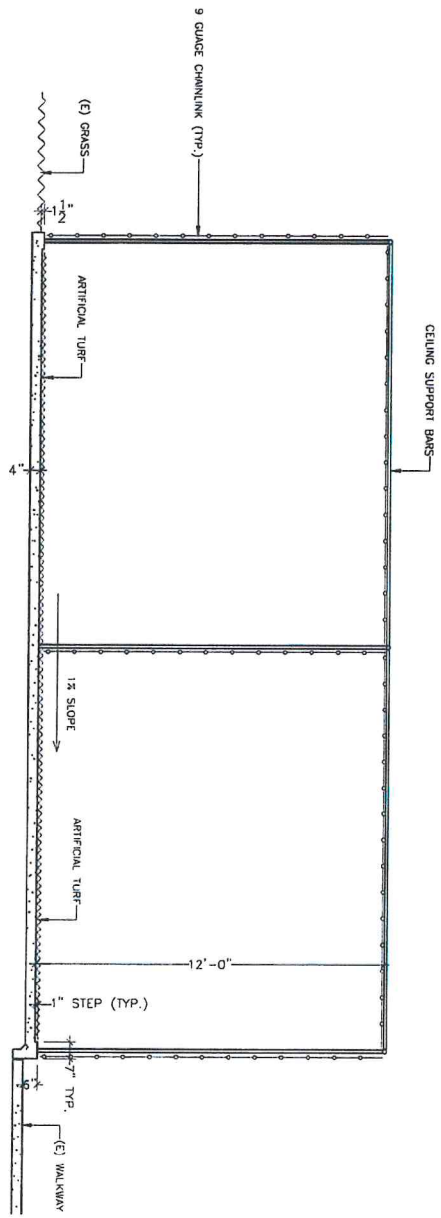

1 SLAB SECTION  
SCALE 1/4" = 1'-0"

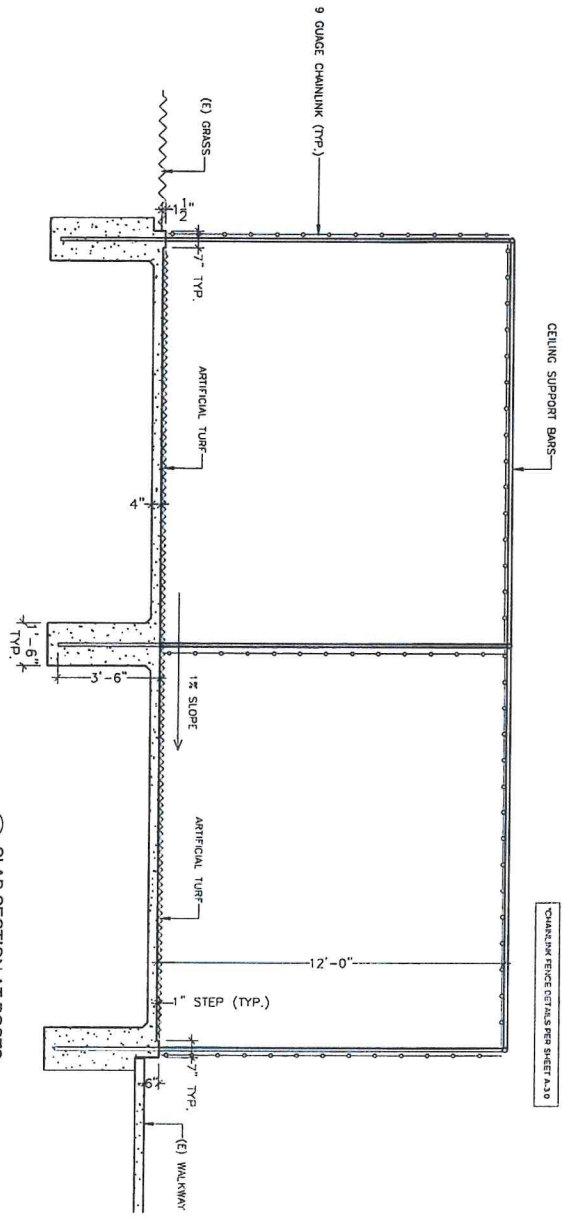

2 SLAB SECTION AT POSTS  
SCALE 1/4" = 1'-0"

CHANNEL FENCE DETAILS PER SHEET A.1.0

<p><b>A-2.0</b></p> <p>DATE PROPOSED: 11/14/20 DATE AS NOTED: 11/14/20 SHEET NO. 3 OF 10</p>	<p>VICTORY PARK 2575 PALOMA ST. PASADENA, CA 91107</p>	<p>DESCRIPTION BATTING CAGE SECTIONS</p>		<p>Office: 1111 E. WALNUT STREET PASADENA, CA 91105 (626) 304-5564 Mailing Address: 115 W. CALIFORNIA BLVD. PMB #139 PASADENA, CA 91105</p>
	<p>Office: 1111 E. WALNUT STREET PASADENA, CA 91105 (626) 304-5564 Mailing Address: 115 W. CALIFORNIA BLVD. PMB #139 PASADENA, CA 91105</p>			

