

LEGEND

- Hahamongna Annex Boundary (29.58 acres)
- Land Use Area Boundary
- A Horse Boarding Area (2.27 acres)
- B Public Equestrian Activity and Event Area (3.6 acres)
- C Common Area (3.58 acres)
 - C1 Park Road, Oak Woodland, Trail
 - C2 Bikeway, Trail, Park Road Extension
 - C3 Trail
 - C4 JPL Easement

- D Therapeutic/Adaptive Area (0.87 acres)
- E Youth Camp Equestrian Area (1.90 acres)
- F Environmental Education Center (5.63 acres)
- G Restored Oak Woodland/Return to Public Use (2.83 acres)
- H Los Angeles County Fire Camp (6.04 acres)
- I Habitat Restoration Area/Parkland (2.86 acres)



0 60 120 240 360 480 Feet 1 inch equals 60 feet



Proposed Uses

Hahamongna Watershed Park Annex - Pasadena, California



April 19, 2007
Prepared by Department of Public Works - Parks and Natural Resources Division

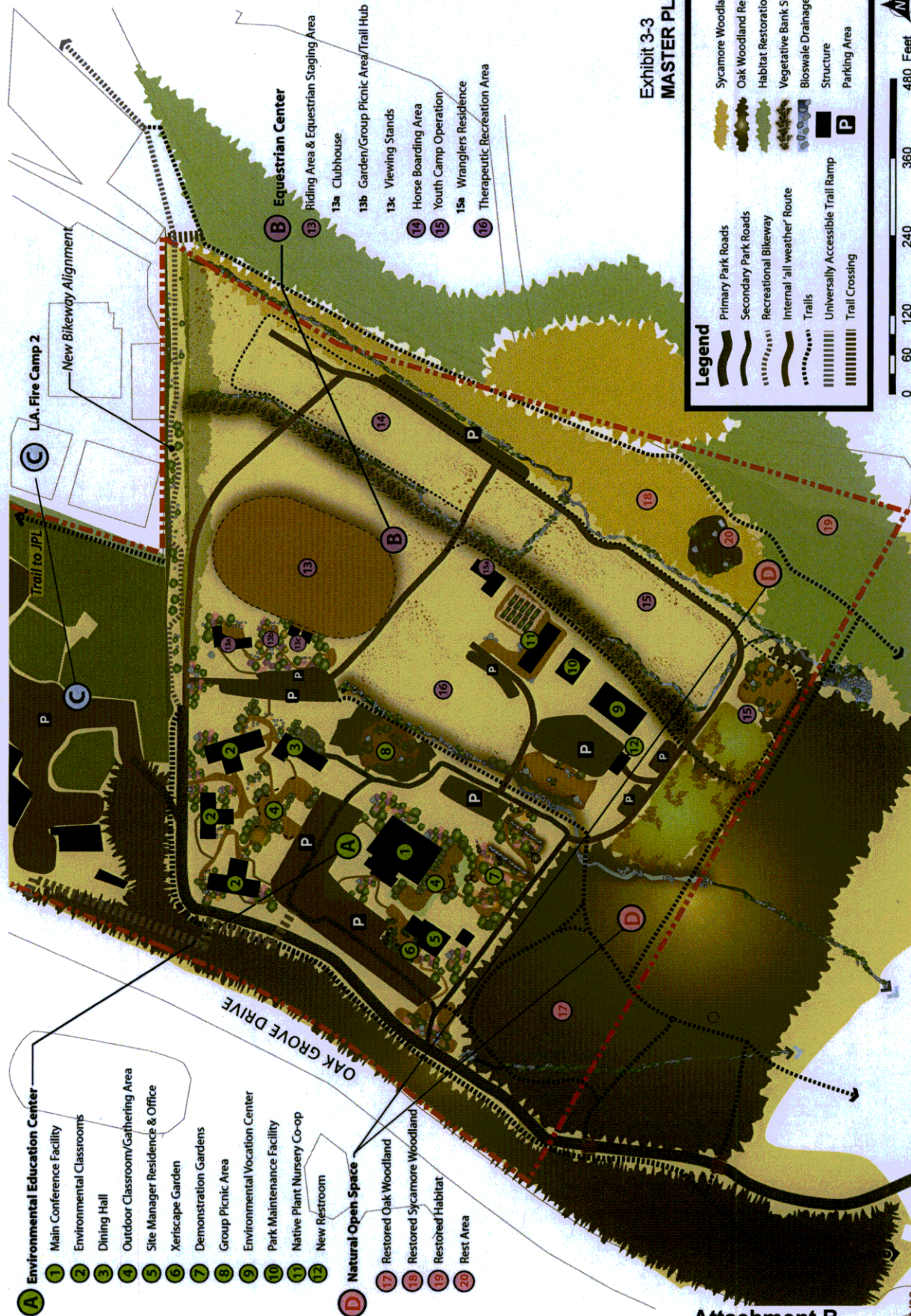

Exhibit 3-3
MASTER PLAN AREA

Attachment B

11/20/09

HAHAMONGNA WATERSHED PARK MASTER PLAN ADDENDUM

MEMORANDUM - CITY OF PASADENA
DEPARTMENT OF PUBLIC WORKS

DATE: April 3, 2012
TO: Michael J. Beck, City Manager
FROM: Siobhan Foster, Director
RE: MACH1 - Therapeutic Horseback Riding Program

The Department of Public Works recently completed a Request for Qualifications (RFQ) for a therapeutic horseback riding program and is pleased to announce Move A Child Higher, Inc. (MACH1) has been selected as the most qualified applicant.

This program will be part of the Pasadena Equestrian Center in Hahamongna Watershed Park. MACH1's future location will be south of the large arena, as described in the Hahamongna Watershed Park Master Plan Addendum.

The City issued twenty-one RFQ packets directly to potential operators who met the established minimum criteria. In addition, the City published the RFQ online on the City's Bid Opportunities list. Two of the potential operators attended a mandatory pre-proposal meeting and finally, the City received a proposal from MACH1.

MACH1 is a Pasadena-based organization that has operated a successful therapeutic horseback riding program in Pasadena since 1996. MACH1 is certified as a Premier Accredited Center of Professional Association of Therapeutic Horsemanship International and are a 501c3 non-profit organization. MACH1's current program is located in northern portion of the Hahamongna Watershed Park equestrian area.

MACH1 is currently preparing its Conditional Use Permit application. Staff is working with MACH1 to develop a lease agreement for the program location and an operating agreement to define the program specifics. The Department of Public Works will bring these items to City Council for consideration upon completion.

Loren Pluth, Project Manager for Parks & Forestry, is coordinating the initiative on behalf of the Department of Public Works. Mr. Pluth is available to provide additional information. You can reach Mr. Pluth by telephone at (626) 744-7329 or via e-mail at lpluth@cityofpasadena.net.

Congratulations to Move A Child Higher!

Attachment C

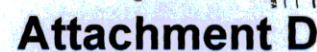

MACH1
MOVE A CHILD HIGHER
THERAPEUTIC EQUESTRIAN CENTER
HAWAIIANMA WATERSHED PARK ANNE
4615 OAK GROVE DRIVE
PALMDALE, CA 91366



WOLFE A. CHILDS, INC.
1438 TORPDA STREET
PASADENA, CA 91104
ALTR. JOY RITEHOUSE, DIRECTOR
(714) 860-2844

PROFESSOR
LABORER IN LOS ANGELES
ACQUITTAL
BORN EAST ALABAMA
ALABAMA, CA 91001
ALVIN RYAN BAY
(602) 710-7127

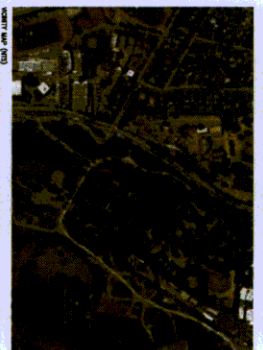

NOTE: (HWPMP ADDENDUM FOR THE HAHAMONGNA ANNEX - SECTION 3.9)

- [illegible]

Current Use Area
Approximate boundary
shown

Proposed Lease Area
Approximate boundary shown

© 2015 Google

Google earth

Attachment E