

**ATTACHMENT A:**

**Map of Proposed Landmark District**

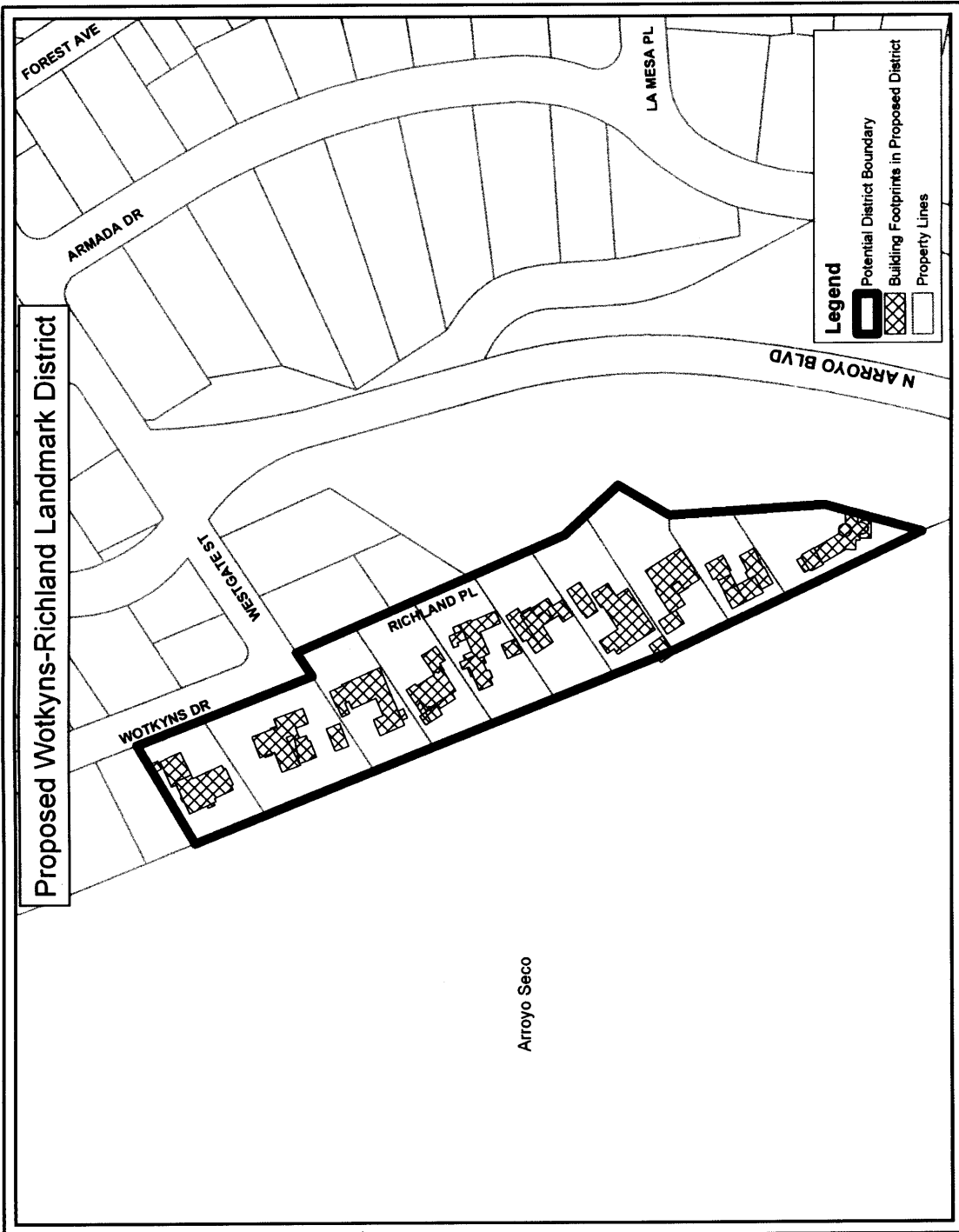

Proposed Wotkyns-Richland Landmark District

**Legend**

- Potential District Boundary
- Building Footprints in Proposed District
- Property Lines

Arroyo Seco

**ATTACHMENT B:**

**Inventory of Properties**

Address	Year Built	Architect	Style	C/NC	Photograph
1 Richland Place	1924	Wallace Neff	Spanish Colonial Revival	C	
2 Richland Place	1923/ 1931	G.W. Bewick (Builder); 1931 second-story designed by Garrett van Pelt	Spanish Colonial Revival	C	
3 Richland Place	1925	Wallace Neff	Italian Renaissance Revival	C	
4 Richland Place	1924	H. Martin	Spanish Colonial Revival	C	
5 Richland Place	1937	Palmer Sabin	Period Revival	C <sup>1</sup>	
6 Richland Place	1925	Steele & Morgan	English Cottage Revival	C	

<sup>1</sup> Period Revival study lists this property as non-contributing due to a second-story addition; however, original Palmer Sabin plans and elevations obtained from the Architecture and Design Collection at the Art, Design & Architecture Museum at University of California, Santa Barbara depict the current configuration of the house

7 Richland Place	1929	Garrett van Pelt, Jr.	English Cottage Revival	C	
8 Richland Place	1939	Archibald Building Co. (Builder)	California Ranch	C	
1119 Wotkyns Drive	1920	Reginald Johnson <sup>2</sup>	Modern Ranch	C	
1125 Wotkyns Drive	1929	William McCay <sup>3</sup>	Monterey Revival	C	

<sup>2</sup> Building permit not found; "Pasadena Houses of the Craftsman Era" by John Ripley lists a house built on this property in 1909 (no architect listed); Johnson, Kaufmann & Coate: Partners in the California Style (Scripps College, 1992) lists a 1920 "alterations" project by Reginald Johnson at this site

<sup>3</sup> Period Revival study erroneously lists Robert Ainsworth as the architect; William McCay is listed on the original building permit