

### Mott Lot

Two options for maximizing parking in the Mott lot are presented in **Figures 11 and 12**. Option 1 in Figure 11 would add one space toward the north of the lot. This area is currently not striped for parking and could accommodate one new stall. Six new stacked parking spaces could be created at the southwest corner of the lot behind the existing parking stalls. Church pastoral staff would park in the existing stalls since they would arrive early and stay late, and other church patrons could park in the stacked spaces behind them. This would add 7 spaces to the lot on Sundays. Option 2 would convert the existing three stalls toward the north end to 6 stacked parking spaces and 1 modified perpendicular stall. The stacked parking in the southwest corner of the lot would also be a part of this option. This option would add 10 spaces to the lot on Sundays.

### Tennis Court Parking

There is an existing tennis court located at the north end of the WCIU campus. On Sunday, the court could serve as additional parking if the entrance gate to the court is modified to accommodate vehicles. Only smaller vehicles would be allowed to park in the tennis court so as to minimize the weight impact on the court pavement and allow for greater vehicle maneuverability. **Figure 13** illustrates how the layout of parking could be accomplished in the tennis court. Although the figure identifies the striping of parking stalls, it is likely that WCIU staff would utilize orange traffic cones to delineate stalls so as not to ruin the nature of the court for days when people would use the court to play tennis. An additional 42 parking spaces could be provided by utilizing the tennis court for parking. Vehicles would access the tennis court parking via the Spear lot.

### Parking Connection between Townsend and Spear Lots

**Figure 14** illustrates where additional paving would be needed to create a connection between the Spear and Townsend lots. Five existing spaces located in the northwest corner of the Townsend lot would be removed, and 30 new parking spaces could be provided that would include 21 perpendicular and 9 parallel spaces. This parking enhancement would have an added benefit of providing alternative access via the Spear lot for users of the Townsend lot.

**Table 7** presents a summary of the parking enhancement options and the number of spaces that would be gained by the enhanced parking options described above for the Townsend, Spear, and Mott lots and the tennis court. The number of existing parking spaces provided in these parking lots is 254, and the number of spaces that could be provided by implementing the most enhanced options would add 126 parking spaces for a total of 380.

**TABLE 7  
SUMMARY OF ON-SITE PARKING ENHANCEMENT OPTIONS**

Parking Lot	Current Spaces Provided	Spaces Provided with Enhancements	
		Minimal Option	Maximal Option
Townsend	139	159	177
Mott	88	95	101
Spear	27	34	35
Tennis Courts	0	0	42
Townsend-Spear Connection	0	0	25
<b>TOTAL</b>	<b>254</b>	<b>288</b>	<b>380</b>

*Source: WCIU, 2004, Kimley-Horn and Associates, Inc.*

September, 2005.

Parking along Sierra Bonita Avenue on Center for World Mission Property

There is an unimproved area on the west side of Sierra Bonita Avenue north of Elizabeth Street. The area is on property owned by the Center for World Mission and is currently closed off by poles and a cable. WCIU could enter into an agreement with the Center to improve this area and utilize it for additional parking on Sundays. This area is approximately 240 feet long and is wide enough to accommodate angled parking. This would yield approximately 28 additional parking spaces. These 28 additional spaces are off-site and would be subject to the Center for World Mission.

Zwemer  
Hall

Gate

New Parking  
Space

Mott  
Auditorium

**LEGEND**

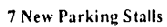
 Proposed Stacked  
Parking Space 18'X9'  
 7 New Parking Stalls

95 Stalls Total

**WCIU TRAFFIC AND PARKING STUDY  
MOTT AUDITORIUM PARKING LOT OPTION 1**

FIGURE 11

Zwemer  
Hall

Gate

New Stacked  
Parking Spaces

Mott  
Auditorium

**LEGEND**

Proposed Stacked  
Parking Space 18'X9'  
13 New Parking Stalls



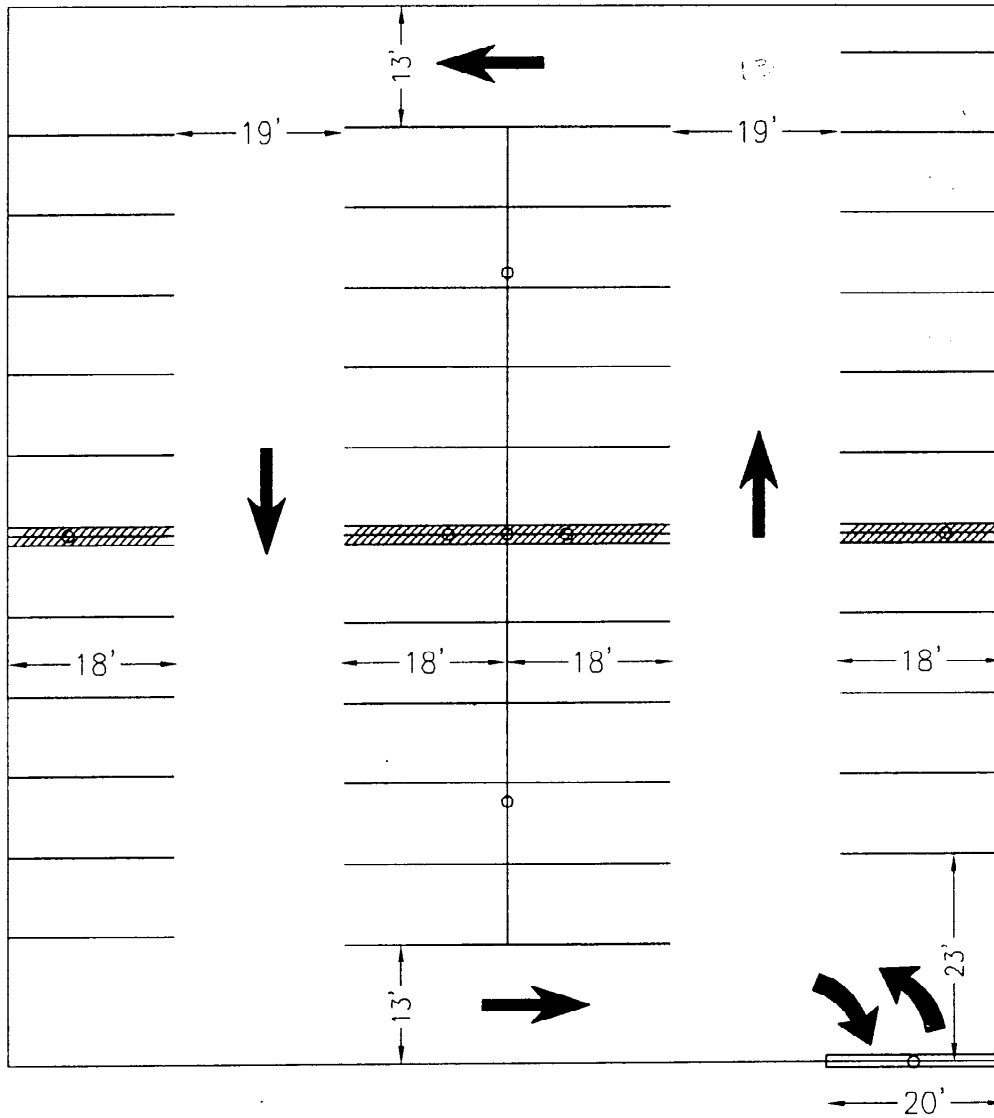

101 Stalls Total

WCIU TRAFFIC AND PARKING STUDY  
MOTT AUDITORIUM PARKING LOT OPTION 2

FIGURE 12

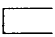

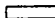
**LEGEND**

	Proposed Parking Space 18'X9'
	Fixed Object
	Gate
	Proposed double striping
42 New Parking Stalls	

**WCIU TRAFFIC AND PARKING STUDY  
TENNIS COURT PARKING OPTION 1**

**FIGURE 13**

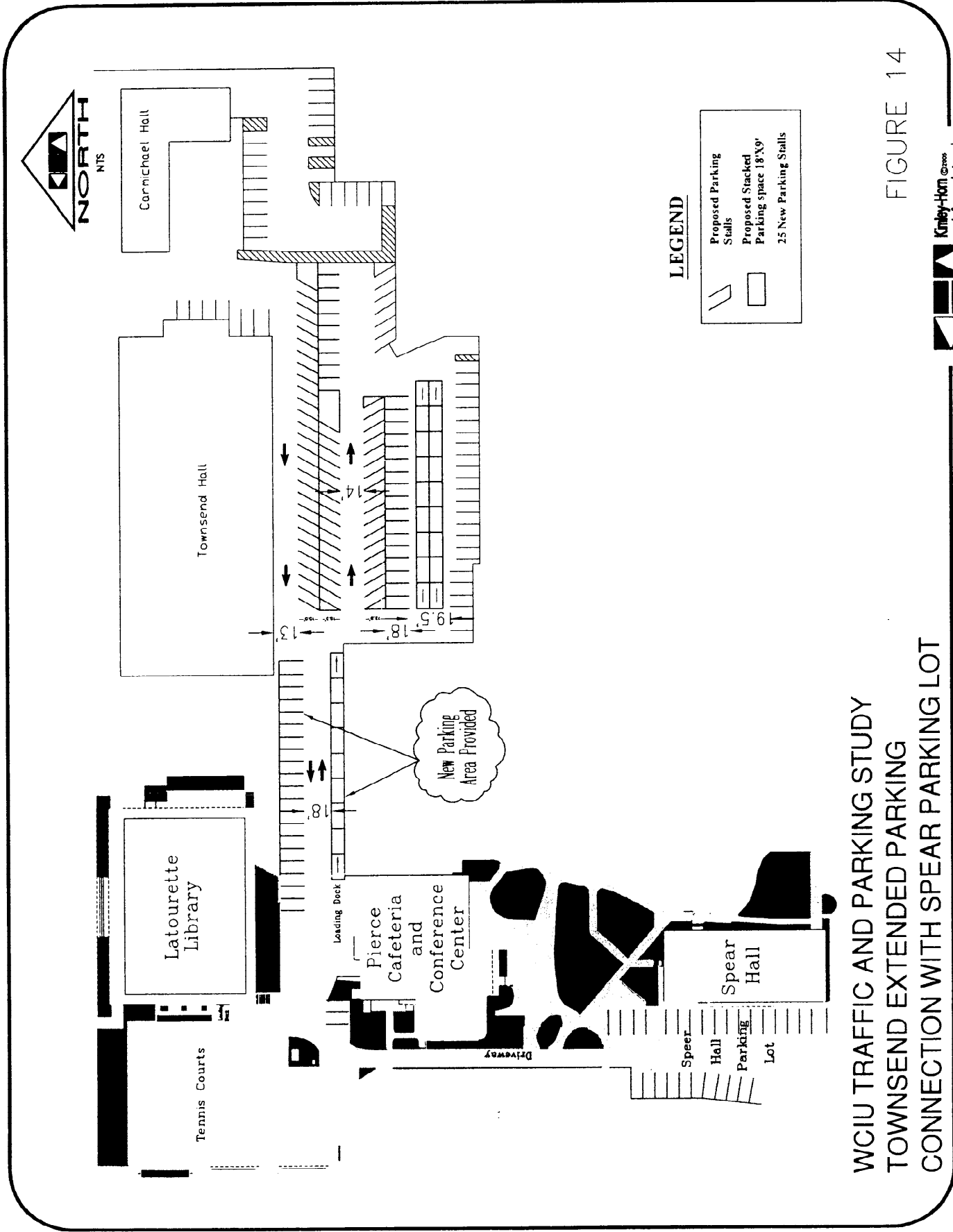

WCIU TRAFFIC AND PARKING STUDY  
 TOWNSEND EXTENDED PARKING  
 CONNECTION WITH SPEAR PARKING LOT

FIGURE 14

## CONCLUSION AND RECOMMENDATIONS

Based on the traffic and parking analyses documented in this report, Sunday campus activities have a greater impact on parking than on traffic in the surrounding neighborhood. Based upon the analysis documented in this report, the following conclusions and recommendations are made.

- On Saturday, one of the six intersections studied operates at LOS B and the remaining intersections operate at LOS A.
- On Sunday, two of the six intersections studied operate at LOS B and the remaining intersections operate at LOS A. The intersection that had a degraded LOS B was Howard Street/Wesley Avenue.
- The roadway analysis indicates that most roadway segments analyzed have less daily traffic on Sunday than on Saturday.
- The parking analysis revealed that many more vehicles are parked on the neighborhood streets on Sunday between 9am and 1pm than on Saturday during the same time period. During the peak hour identified between 9am and 1pm, the number of on-street parked vehicles was 140 on Saturday and 302 on Sunday.
- The City of Pasadena may desire to provide on-street parking striping similar to metered space striping and red curb near driveways in order to provide better guidance on where and how to park to avoid blocking driveways or otherwise impacting neighbors.
- Figures 7 through 14 illustrate options for accommodating more parked vehicles on the campus during Sunday church services. The number of spaces that could be provided by implementing the most enhanced options would provide 126 additional parking spaces for use on Sunday.

**APPENDIX A:**  
**TRAFFIC COUNT SHEETS**



**Sunday Traffic Counts at Washington/Sierra Bonita, Hill/Howard and Hill/Elizabeth**

**Intersection of Washington Blvd. & North Sierra Bonita Ave. (NSB)**

**Saturday, June 18, 2005**

	10-10:30	10:30-11	11-11:30	11:30-12	12-12:30	12:30-1	1-1:30
NSB - north turning west on Washington	4	2	0	2	2	3	0
NSB - north toward campus	0	0	2	6	0	0	0
NSB - north turning east on Washington	0	1	2	2	1	0	2
NSB - south turning east on Washington	9	5	7	3	6	8	5
NSB - south past Washington	2	2	3	6	2	0	0
NSB - south turning west on Washington	5	3	1	2	0	7	1
Washington - east turning north	3	1	0	3	4	2	3
Washington - east not turning	248	245	217	235	279	232	212
Washington - east turning south	0	2	1	2	0	0	1
Washington - west turning south	1	0	3	1	1	0	0
Washington - west not turning	267	225	205	207	256	223	295
Washington - west turning north	3	3	2	1	0	1	1

**Sunday, June 19, 2005**

	10-10:30	10:30-11	11-11:30	11:30-12	12-12:30	12:30-1	1-1:30
NSB - north turning west on Washington	0	1	0	5		2	5
NSB - north toward campus	0	0	1	0		2	5
NSB - north turning east on Washington	0	0	2	1		13	7
NSB - south turning east on Washington	2	3	8	2		16	6
NSB - south past Washington	0	0	1	1		3	4
NSB - south turning west on Washington	5	3	7	3		28	8
Washington - east turning north	1	1	2	0		6	1
Washington - east not turning	155	160	130	181		170	180
Washington - east turning south	0	1	0	2		4	0
Washington - west turning south	1	0	0	1		2	3
Washington - west not turning	205	175	165	158		191	124
Washington - west turning north	3	1	9	3		5	3

**Intersection of Hill Ave. & Elizabeth St.**

	9-9:30	9:30-10	10-10:30	10:30-11	11-11:30	11:30-12	12-12:30	12:30-1	1-1:30
Hill - north turning west on Elizabeth	2	2	1	0	1	0	1	0	3
Hill - north not turning	27	41	49	42	51	36	52	26	42
Hill - north turning east on Elizabeth	19	20	6	8	6	4	6	2	6
Hill - south turning east on Elizabeth	1	1	2	1	3	0	0	0	0
Hill - south not turning	30	36	41	27	37	36	31	31	46
Hill - south turning west on Elizabeth	0	1	1	0	0	0	0	0	0
Elizabeth - east turning north on Hill	0	0	0	1	1	0	0	0	0
Elizabeth - east toward campus	3	1	0	2	6	0	0	0	0
Elizabeth - east turning south on Hill	3	2	2	1	0	1	0	2	2
Elizabeth - west turning south on Hill	3	3	4	0	3	0	0	0	0
Elizabeth - west past Hill	0	0	0	0	3	0	0	0	0
Elizabeth - west turning north on Hill	1	2	1	0	0	7	5	1	3

**Sunday, June 26, 2005**

	9-9:30	9:30-10	10-10:30	10:30-11	11-11:30	11:30-12	12-12:30	12:30-1	1-1:30
Hill - north turning west on Elizabeth	2	3	3	11	2	3	3	2	1
Hill - north not turning	43	42	51	63	55	48	73	60	41
Hill - north turning east on Elizabeth	22	17	22	33	35	10	12	7	6
Hill - south turning east on Elizabeth	11	9	11	4	4	0	2	2	0
Hill - south not turning	61	95	95	109	101	86	109	83	52
Hill - south turning west on Elizabeth	0	0	0	2	0	0	0	6	3
Elizabeth - east turning north on Hill	0	0	0	0	1	1	0	0	0
Elizabeth - east toward campus	3	3	3	1	2	0	0	1	1
Elizabeth - east turning south on Hill	5	13	13	9	10	5	5	3	4
Elizabeth - west turning south on Hill	11	7	7	46	22	7	41	17	11
Elizabeth - west past Hill	0	0	0	0	1	0	2	1	1
Elizabeth - west turning north on Hill	1	4	4	5	4	1	7	7	2

Sunday Traffic Counts at Howard Street Intersections and Parking Lots

	8am-8:30	8:30-9	9-9:30	9:30-10	10-10:30	10:30-11	11-11:30	11:30-12	12-12:30	12:30-1
<b>Sunday April 24, 2005</b>										
Bresee N turning E on Howard				5	1	4	2		2	2
Howard W turning S on Bresee	1	2	3	4	3	1	1		2	8
Bresee N turning W on Howard		2	3	3	2	6	8	1	3	7
Howard E turning S on Bresee	2	5	10	3	1	5	6	2		9
NSB N turning E into Mott lot		7	1	4		6	14		1	4
Mott lot turning S on NSB			1	2	2	1	3		3	16
Mott lot turning W on Howard	2	1	1	2	4	5	3		4	38
NSB N turning W on Howard		1	2	4		10	3	4	3	10
Howard W into Speer Lot								1	1	1
Speer lot turning W on Howard	1	3	1							5
Speer lot turning E on Howard		1						1		3
Howard E turning S on NSB		4	6	5	7	2	8	1	4	14
Howard at NSB E into Mott lot	3	17	7	20	9	8	30		2	2

(NSB = North Sierra Bonita Ave.)

Sunday Traffic Counts at Howard Street Intersections and Parking Lots

Sunday, May 1, 2005

	8am-8:30	8:30-9am	9am-9:30	9:30-10am	10am-10:30	10:30-11am	11am-11:30	11:30-12pm	12pm-12:30	12:30-1pm
Howard at NSB E into Mott lot	8	14	16	8	10	31	11	2	2	3
Howard at Wesley E from Hill	4	8	31	29	29	91	101	19	15	15
Wesley N turning E on Howard	2	1	1	2		3	5		3	2
Wesley S turning E on Howard	3	6	3	4		4	2	3		12
NSB N turning E into Mott lot	1	4	6	3	2	7	3	1	2	1
Bresee N turning E on Howard			5		1	9	4	1	2	1
Mott lot turning S on NSB			1		4			1	1	9
Mott lot turning W on Howard		1	2	3	5		5	3	1	28
Howard W turning S on Bresee	1					1	2			3
Howard W turning S on Wesley			1	2	1	3	1		5	7
Howard W to Hill		1	10	4	12	7	8	6	17	39
NSB N turning W on Howard	1			5	3	8	6	2	2	4
Bresee N turning W on Howard	2		6		4	4	3	3	1	3
Howard W into Speer Lot	2		2					1		
Howard W turning N on Wesley			3	1	3	2	7	2	4	8
Speer lot turning W on Howard			1						1	8
Speer lot turning E on Howard										2
Howard E turning S on Bresee			1	1	5	2	4	1	1	4
Howard E turning S on NSB			3	2	6	15	12	2	4	7
Wesley N to Elizabeth	5	2	6	13	6	12	16	7	9	9
Wesley N turning W on Howard	1		1	1		2	1	1	1	
Wesley S to Washington	5	6	8	16	8	18	8	11	30	31
Wesley S turning W on Howard	2	4	3	3	2	5	1	4	13	6
Howard E turning N on Wesley			4	9	4	34	68	3	4	4
Howard E turning S on Wesley			10	6	6	16	14	8	2	4

(NSB = North Sierra Bonita Ave.)

Sunday Traffic Counts at Howard Street Intersections and Parking Lots

Sunday, May 15, 2005

	8am-8:30	8:30-9am	9am-9:30	9:30-10am	10am-10:30	10:30-11am	11am-11:30	11:30-12pm	12pm-12:30	12:30-1pm
Howard at NSB E into Mott lot	10	17	21	26	6	36	1	2	2	2
Howard at Wesley E from Hill	8	8	13	22	8	58	15	11	5	10
Wesley N turning E on Howard	2	3	4	4		1	4	1		2
Wesley S turning E on Howard	2	3	2	4		5	1	4	3	4
NSB N turning E into Mott lot	2	4	5	8	1	7	1	1		2
Bresee N turning E on Howard	2	4	3	7	5	3	3	2	2	2
Mott lot turning S on NSB	1	5	2	2	5	3	3	3	9	15
Mott lot turning W on Howard					4	13		3	9	43
Howard W turning S on Bresee				2	4	2		1	1	4
Howard W turning S on Wesley			1	2		1	1		5	13
Howard W to Hill	2	5	3	3	1	3	5	6	5	31
NSB N turning W on Howard	1	1	3	3	3	4	5	5	3	9
Bresee N turning W on Howard	2	2	2	4	3		1	1	4	2
Howard W into Speer Lot	1	3	2	1	1		1			
Howard W turning N on Wesley					1	3	6	2	3	15
Speer lot turning W on Howard							2			8
Speer lot turning E on Howard								1		1
Howard E turning S on Bresee			1	2		2				1
Howard E turning S on NSB	3	2	3	8	6	3	6	1	1	9
Wesley N to Elizabeth					1	13	7	8	3	7
Wesley N turning W on Howard		1				1	1	2	4	1
Wesley S to Washington	5	3	5	12	9	8	8	8	14	16
Wesley S turning W on Howard				3		2	5	3	2	9
Howard E turning N on Wesley			1	2	1	32	45	5	5	2
Howard E turning S on Wesley	1				1	12	4	4	2	1

(NSB = North Sierra Bonita Ave.)

**Saturday, June 4, 2005**

Wesley N turning W on Howard  
 Wesley N to Elizabeth  
 Wesley N turning E on Howard  
 Wesley S turning E on Howard  
 Wesley S to Washington  
 Wesley S turning W on Howard  
 Howard E turning N on Wesley  
 Howard at Wesley E from Hill  
 Howard E turning S on Wesley  
 Howard W turning S on Wesley  
 Howard W to Hill  
 Howard W turning N on Wesley

	8am-8:30	8:30-9am	9am-9:30	9:30-10am	10am-10:30	10:30-11am	11am-11:30	11:30-12pm	12pm-12:30	12:30-1pm	1pm-1:30
NBL	0	0	0	0	0	8	2	1	1	5	2
NBT	3	1	5	4	2	3	4	5	6	5	6
NBR	2	1	1	2	2	6	2	3	5	6	9
SBL	1	0	6	7	2	2	7	6	2	4	5
SBT	5	2	1	3	6	2	3	5	4	8	5
SBR	0	1	3	1	1	1	1	2	2	0	3
EBL	1	0	0	4	1	1	2	1	0	3	4
EBT	0	2	2	3	5	2	5	6	12	6	18
EBR	0	1	1	1	0	1	1	2	1	5	1
WBL	0	0	0	1	0	1	5	1	4	0	3
WBT	0	3	5	7	2	3	8	8	3	5	6
WBR	3	1	5	7	4	3	12	7	4	4	4

**Saturday, June 4, 2005**

	8am-8:30	8:30-9am	9am-9:30	9:30-10am	10am-10:30	10:30-11am	11am-11:30	11:30-12pm	12pm-12:30	12:30-1pm	1pm-1:30
Bresee N turning E on Howard	2	3	0	1	2	4	6	4	1	1	0
Howard W turning S on Bresee	0	0	4	0	1	0	0	1	1	3	2
Bresee N turning W on Howard	0	4	2	2	3	1	5	3	5	8	4
Howard E turning S on Bresee	1	1	0	6	4	3	6	7	3	13	0
NSB N turning E into Mott lot	0	0	0	0	1	0	0	0	0	0	1
Mott lot turning S on NSB	0	0	0	0	0	0	0	0	0	0	0
Mott lot turning W on Howard	0	0	1	0	1	1	0	1	3	2	0
NSB N turning W on Howard	2	0	2	3	2	0	3	3	10	5	2
Howard W into Speer Lot	1	2	0	0	0	0	0	0	0	0	0
Speer lot turning W on Howard	0	0	0	0	0	0	0	0	0	1	0
Speer lot turning E on Howard	0	1	0	0	0	0	0	0	0	0	0
Howard E turning S on NSB	1	2	0	0	1	8	7	6	8	6	1
Howard at NSB E into Mott lot	0	0	0	1	3	1	0	2	2	1	1

(NSB = North Sierra Bonita Ave.)

**Intersection of Hill Ave. & Howard St.**

**Saturday, June 18, 2005**

Hill - north not turning  
 Hill - north turning east on Howard  
 Hill - south turning east on Howard  
 Hill - south not turning  
 Howard - west turning south on Hill  
 Howard - west turning north on Hill

	9:30-10	10-10:30	10:30-11	11-11:30	11:30-12	12-12:30	12:30-1	1-1:30
NBT	75	83	90	100	105	124	100	108
NBR	13	17	20	21	20	20	13	8
SBL	3	6	5	5	2	3	5	1
SBT	83	95	100	110	120	120	100	87
WBL	3	10	5	5	2	8	7	2
WBR	2	2	6	4	7	10	8	3

**Sunday, June 19, 2005**

Hill - north not turning  
 Hill - north turning east on Howard  
 Hill - south turning east on Howard  
 Hill - south not turning  
 Howard - west turning south on Hill  
 Howard - west turning north on Hill

	9:30-10	10-10:30	10:30-11	11-11:30	11:30-12	12-12:30	12:30-1	1-1:30
NBT	70	86	140	165	85	60	170	73
NBR	11	12	19	23	7	16	24	24
SBL	3	1	0	4	5	5	6	3
SBT	110	100	120	125	130	45	130	72
WBL	8	3	7	13	3	8	28	11
WBR	2	0	5	8	3	6	17	7



**Sunday April 24, 2005**

	8am-8:30	8:30-9	9-9:30	9:30-10	10-10:30	10:30-11	11-11:30	11:30-12	12-12:30	12:30-1
Wesley N turning W on Howard						1	1			
Wesley N to Elizabeth	3	4	2	6	6	2	2	7	7	6
Wesley N turning E on Howard	1	2	1	2	2	2	2	2	2	7
Wesley S turning E on Howard	2	2	5	7	1	1	2	2	2	1
Wesley S to Washington	2	10	6	7	5	10	8	6	8	21
Wesley S turning W on Howard	3	4	2	2	2	7	7	2	2	5
Howard E turning N on Wesley		4	6	6	7	25	35	4	3	7
Howard at Wesley E from Hill	3	21	13	23	14	36	8	4	7	6
Howard E turning S on Wesley		2	4	2	1	15	1	4	5	5
Howard W turning S on Wesley		1	1	1	1	2		4	1	11
Howard W to Hill	2	1	6	1	4	4		6	3	23
Howard W turning N on Wesley		3	2	3	1	2		3	2	8

NBL  
NBT  
NBR  
SBL  
SBT  
SBR  
EBL  
EBT  
EBR  
WBL  
WBT  
WBR

**Sunday, May 1, 2005**

	8am-8:30	8:30-9am	9am-9:30	9:30-10am	10am-10:30	10:30-11am	11am-11:30am	11:30am-12pm	12pm-12:30pm	12:30-1pm
Wesley N turning W on Howard	1		1	1	2	2	1	1	1	
Wesley N to Elizabeth	5	2	6	13	6	12	16	7	9	9
Wesley N turning E on Howard	2	1	1	2	3	3	5	3	3	2
Wesley S turning E on Howard			3	4		4	2	3	3	12
Wesley S to Washington	5	6	8	16	8	18	8	11	30	31
Wesley S turning W on Howard	2	4	3	3	2	5	1	4	13	6
Howard E turning N on Wesley			4	9	4	34	68	3	4	4
Howard at Wesley E from Hill	4	8	31	29	29	91	101	19	15	15
Howard E turning S on Wesley			10	6	6	16	14	8	2	4
Howard W turning S on Wesley		1	1	2	1	3	1	5	5	7
Howard W to Hill		1	10	4	12	7	8	6	17	39
Howard W turning N on Wesley			3	1	3	2	7	2	4	8

NBL  
NBT  
NBR  
SBL  
SBT  
SBR  
EBL  
EBT  
EBR  
WBL  
WBT  
WBR

**Sunday, May 15, 2005**

	8am-8:30	8:30-9am	9am-9:30	9:30-10am	10:30-11am	11am-11:30am	11:30am-12pm	12pm-12:30	12:30-1pm
Wesley N turning E on Howard	2	3	4	4	1	4	1		2
Wesley N to Elizabeth	3	2	3	8	13	7	8	3	7
Wesley N turning W on Howard		1			1	1	2	4	1
Wesley S turning E on Howard	2	3	2	4	5	1	4	3	4
Wesley S to Washington	5	3	5	12	8	8	8	14	16
Wesley S turning W on Howard				3	2	5	3	2	9
Howard E turning N on Wesley			1	2	32	45	5	5	2
Howard at Wesley E from Hill	8	8	13	22	58	15	11	5	10
Howard E turning S on Wesley	1				12	4	4	2	1
Howard W turning S on Wesley		1	1	2	1	1		5	13
Howard W to Hill	2	5	3	3	3	5	6	5	31
Howard W turning N on Wesley				1	3	6	2	3	15

NBR  
NBT  
NBL  
SBL  
SBT  
SBR  
EBL  
EBT  
EBR  
WBL  
WBT  
WBR

Sunday Traffic Counts at Howard Street Intersections and Parking Lots

	8am-8:30	8:30-9	9-9:30	9:30-10	10-10:30	10:30-11	11-11:30	11:30-12	12-12:30	12:30-1
<b>Sunday April 24, 2005</b>										
Howard at NSB E into Mott lot	3	17	7	20	9	8	30		2	2
Howard at Wesley E from Hill	3	21	13	23	14	36	8	4	7	6
Wesley N turning E on Howard	1	2	1	2	2		2	2	2	7
Wesley S turning E on Howard	2	2	5	7	1	1	2	2	2	1
NSB N turning E into Mott lot		7	1	4		6	14		1	4
Bresee N turning E on Howard		3	3	5	1	4	2		2	2
Mott lot turning S on NSB			1	2	2	1	3		3	16
Mott lot turning W on Howard	2	1		2	4	5	3		4	38
Howard W turning S on Bresee	1	2		4	3	1	1		2	8
Howard W turning S on Wesley		1	1	4	1	2			1	11
Howard W to Hill	2	1	6	1	4	4			3	23
NSB N turning W on Howard		1	2	4		10	3		3	10
Bresee N turning W on Howard		2	3	3	2	6	8		3	7
Howard W into Speer Lot									1	1
Howard W turning N on Wesley		3	2	3	1	2		3	2	8
Speer lot turning W on Howard	1	3	1							5
Speer lot turning E on Howard		1								3
Howard E turning S on Bresee	2	5	10	3	1	5	6	1	1	3
Howard E turning S on NSB		4	6	5	7	2	8	2	4	9
Wesley N to Elizabeth	3	4	2	6	6	2	2	7	7	14
Wesley N turning W on Howard						1	1			6
Wesley S to Washington	2	10	6	7	5	10	8	6	8	21
Wesley S turning W on Howard	3	4	2	2	2		7		2	5
Howard E turning N on Wesley		4	6	6	7	25	35	4	3	7
Howard E turning S on Wesley		2	4	2	1	15	1	4	5	5

(NSB = North Sierra Bonita Ave.)

Sunday Traffic Counts at Howard Street Intersections and Parking Lots

	8am-8:30	8:30-9am	9am-9:30	9:30-10am	10am-10:30	10:30-11am	11am-11:30	11:30-12pm	12pm-12:30	12:30-1pm	1pm-1:30
Howard at NSB E into Mott lot	8	14	16	8	10	31	11	2	2	3	5
Howard at Wesley E from Hill	4	8	31	29	29	91	101	19	15	15	16
Wesley N turning E on Howard	2	1	1	2		3	5	3	3	2	
Wesley S turning E on Howard			3	4		4	2	3		12	
NSB N turning E into Mott lot	3	6	6	3	2	7	3	1	2	1	5
Bresee N turning E on Howard	1	4	5	3	1	9	4	1	2	1	1
Mott lot turning S on NSB			1		4			1	1	9	6
Mott lot turning W on Howard		1	2	3	5		5	3	1	28	18
Howard W turning S on Bresee	1		1	2	1	1	2		5	3	5
Howard W turning S on Wesley			10	4	12	7	8	6	17	7	3
Howard W to Hill		1		5		8	6	2	2	4	22
NSB N turning W on Howard	1		6	5	3	8	6	2	2	4	7
Bresee N turning W on Howard	2		2	4	4	4	3	3	1	3	2
Howard W into Speer Lot	2		3	1	3	2	7	1	4	8	7
Howard W turning N on Wesley			1					2	1	8	1
Speer lot turning W on Howard			1							2	
Speer lot turning E on Howard			1		5	2	4	1	1	4	
Howard E turning S on Bresee			3	2	6	15	12	2	4	7	5
Howard E turning S on NSB			6	13	6	12	16	7	9	9	7
Wesley N to Elizabeth	5	2	1	1		2	1	1	1	1	1
Wesley N turning W on Howard	1		8	16	8	18	8	11	30	31	13
Wesley S to Washington	5	6	4	3	2	5	1	4	13	6	2
Wesley S turning W on Howard	2	4	9	9	4	34	68	3	4	4	6
Howard E turning N on Wesley			10	6	6	16	14	8	2	4	4
Howard E turning S on Wesley											

(NSB = North Sierra Bonita Ave.)

Sunday Traffic Counts at Howard Street Intersections and Parking Lots

	8am-8:30	8:30-9am	9am-9:30	9:30-10am	10am-10:30	10:30-11am	11am-11:30	11:30-12pm	12pm-12:30	12:30-1pm	1pm-1:30
Howard at NSB E into Mott lot	10	17	21	26	6	36	1	2	2	2	
Howard at Wesley E from Hill	8	8	13	22	8	58	15	11	5	10	2
Wesley N turning E on Howard	2	3	4	4		1	4	1		2	
Wesley S turning E on Howard	2	3	2	4		5	1	4	3	4	1
NSB N turning E into Mott lot	2	4	5	8	1	7	1	1		2	
Bresee N turning E on Howard	2	4	3	7	5	3		2		2	
Mott lot turning S on NSB			3		4	3		2	2	15	2
Mott lot turning W on Howard	1	5	2	2	5	13		3	9	43	5
Howard W turning S on Bresee			2	2	4	2			1	4	1
Howard W turning S on Wesley		1	1	2		1	1		5	13	1
Howard W to Hill	2	5	3	3	1	3	5	6	5	31	5
NSB N turning W on Howard	1	1		3	3	4	5	5	3	9	
Bresee N turning W on Howard	2	2	2	4	3		1	1	4	2	1
Howard W into Speer Lot	1	3	2	1	1		1	2			
Howard W turning N on Wesley			2	1	1	3	6	2	3	15	1
Speer lot turning W on Howard							2			8	
Speer lot turning E on Howard								1		1	
Howard E turning S on Bresee			1	2		2				1	
Howard E turning S on NSB		1	2	2	6	3	6	1	1	9	2
Wesley N to Elizabeth	3	2	3	8	1	13	7	8	3	7	
Wesley N turning W on Howard		1				1	1	2	4	1	1
Wesley S to Washington	5	3	5	12	9	8	8	8	14	16	
Wesley S turning W on Howard				3		2	5	3	2	9	
Howard E turning N on Wesley			1	2	1	32	45	5	5	2	
Howard E turning S on Wesley	1				1	12	4	4	2	1	1

(NSB = North Sierra Bonita Ave.)

Sunday Traffic Counts at Howard Street Intersections and Parking Lots

	8am-8:30	8:30-9am	9am-9:30	9:30-10am	10am-10:30	10:30-11am	11am-11:30	11:30-12pm	12pm-12:30	12:30-1pm
<b>Sunday Average</b>										
Howard at NSB E into Mott lot	7	16	15	18	8	25	14	1	2	2
Howard at Wesley E from Hill	5	12	19	25	17	62	41	11	9	10
Wesley N turning E on Howard	2	2	2	3	1	1	4	1	2	4
Wesley S turning E on Howard	1	2	3	5	0	3	2	3	2	6
NSB N turning E into Mott lot	2	6	4	5	1	7	6	1	1	2
Bresee N turning E on Howard	1	4	4	4	2	5	2	0	1	2
Mott lot turning S on NSB	0	0	2	1	3	1	1	1	2	13
Mott lot turning W on Howard	1	2	1	2	5	6	3	2	5	36
Howard W turning S on Bresee	1	1	0	2	2	1	1	0	1	5
Howard W turning S on Wesley	0	1	1	1	1	2	1	0	4	10
Howard W to Hill	1	2	6	3	6	5	4	6	8	31
NSB N turning W on Howard	1	1	1	4	2	7	5	4	3	8
Bresee N turning W on Howard	1	1	4	2	3	3	4	2	3	4
Howard W into Speer Lot	1	1	1	0	0	0	0	1	0	0
Howard W turning N on Wesley	0	1	2	1	2	2	4	2	3	10
Speer lot turning W on Howard	0	1	1	0	0	0	1	0	0	7
Speer lot turning E on Howard	0	0	0	0	0	0	0	1	0	2
Howard E turning S on Bresee	1	2	4	2	2	3	3	1	1	5
Howard E turning S on NSB	0	2	3	3	6	7	9	1	3	10
Wesley N to Elizabeth	4	3	4	9	4	9	8	7	6	7
Wesley N turning W on Howard	0	0	0	0	0	1	1	1	2	0
Wesley S to Washington	4	6	6	12	7	12	8	8	17	23
Wesley S turning W on Howard	2	3	1	3	1	2	4	2	6	7
Howard E turning N on Wesley	0	1	4	6	4	30	49	4	4	4
Howard E turning S on Wesley	0	1	5	3	3	14	6	5	3	3

(NSB = North Sierra Bonita Ave.)

Sunday Traffic Counts at Howard Street Intersections and Parking Lots

Saturday, June 4 or 11, 2005

	8am-8:30	8:30-9am	9am-9:30	9:30-10am	10am-10:30	10:30-11am	11am-11:30	11:30-12pm	12pm-12:30	12:30-1pm
Howard at NSB E into Mott lot	0	0	0	1	3	1	0	2	2	1
Howard at Wesley E from Hill	0	2	2	3	5	2	5	6	12	6
Wesley N turning E on Howard	2	1	6	2	2	6	2	3	5	6
Wesley S turning E on Howard	1	0	6	7	2	2	7	6	2	4
NSB N turning E into Mott lot	0	0	0	0	1	0	0	0	0	0
Bresee N turning E on Howard	2	3	0	1	2	4	6	4	1	1
Mott lot turning S on NSB	0	0	0	0	0	0	0	0	0	0
Mott lot turning W on Howard	0	0	1	0	1	1	0	1	3	2
Howard W turning S on Bresee	0	0	4	0	1	0	0	1	1	3
Howard W turning S on Wesley	0	0	0	1	0	1	5	1	4	0
Howard W to Hill	0	3	5	7	2	3	8	8	3	5
NSB N turning W on Howard	2	0	2	3	2	0	3	3	10	5
Bresee N turning W on Howard	0	4	2	2	3	1	5	3	5	8
Howard W into Speer Lot	1	2	0	0	0	0	0	0	0	0
Howard W turning N on Wesley	3	1	5	7	4	3	12	7	4	4
Speer lot turning W on Howard	0	0	0	0	0	0	0	0	0	1
Speer lot turning E on Howard	0	1	0	0	0	0	0	0	0	0
Howard E turning S on Bresee	1	1	0	6	4	3	6	7	3	13
Howard E turning S on NSB	1	2	0	0	1	8	7	6	8	6
Wesley N to Elizabeth	3	1	5	4	2	3	4	5	6	5
Wesley N turning W on Howard	0	0	0	0	0	8	2	1	1	5
Wesley S to Washington	5	2	1	3	6	2	3	5	4	8
Wesley S turning W on Howard	0	1	3	1	1	1	1	2	2	0
Howard E turning N on Wesley	1	0	0	4	1	1	2	1	0	3
Howard E turning S on Wesley	0	1	1	1	0	1	1	2	1	5

**Saturday and Sunday Counts at Elizabeth Street/Oxford Street**

**Saturday June 4, 2005**

	8am-8:30	8:30-9am	9am-9:30	9:30-10am	10am-10:30	10:30-11am	11am-11:30	11:30-12pm	12pm-12:30	12:30-1pm	1pm-1:30
Oxford N turning W on Elizabeth	NBL 4	9	10	10	15	15	5	2	0	5	8
Oxford N to New York	NBT 1	2	0	2	3	5	2	5	5	5	5
Oxford N turning E on Elizabeth	NBR 1	0	0	1	0	3	0	1	0	1	1
Oxford S turning E on Elizabeth	SBL 6	8	22	5	15	5	1	0	2	0	1
Oxford S to Washington	SBT 2	2	9	4	20	2	4	5	8	15	3
Oxford S turning W on Elizabeth	SBR 2	6	7	5	5	8	3	6	3	5	7
Elizabeth E turning N on Oxford	EBL 1	6	6	0	2	10	5	7	5	13	13
Elizabeth E from Hill to Allen	EBT 7	8	22	5	15	10	7	9	16	32	20
Elizabeth E turning S on Oxford	EBR 6	9	27	12	26	6	12	15	26	62	33
Elizabeth W turning S on Oxford	WBL 0	0	4	2	1	3	0	0	3	0	0
Elizabeth W from Allen	WBT 6	15	17	15	20	20	11	15	10	15	8
Elizabeth W turning N on Oxford	WBR 2	8	7	15	12	30	16	17	11	17	11

**Sunday June 5, 2005**

	8am-8:30	8:30-9am	9am-9:30	9:30-10am	10am-10:30	10:30-11am	11am-11:30	11:30-12pm	12pm-12:30	12:30-1pm	1pm-1:30
Oxford N turning W on Elizabeth	NBL 14	13	17	13	12	18	13	21	18	16	19
Oxford N to New York	NBT 5	2	10	6	9	7	8	8	10	11	7
Oxford N turning E on Elizabeth	NBR 3	3	1	2	3	1	2	1	2	6	4
Oxford S turning E on Elizabeth	SBL 8	14	20	17	26	23	20	23	22	27	22
Oxford S to Washington	SBT 6	3	12	5	11	5	9	10	5	10	9
Oxford S turning W on Elizabeth	SBR 5	7	6	9	5	5	4	2	8	7	2
Elizabeth E turning N on Oxford	EBL 6	6	5	8	7	6	4	9	5	10	3
Elizabeth E from Hill to Allen	EBT 11	17	21	17	26	23	20	23	22	27	22
Elizabeth E turning S on Oxford	EBR 9	20	25	15	21	14	13	22	18	24	18
Elizabeth W turning S on Oxford	WBL 3	5	3	1	3	2	2	3	8	3	1
Elizabeth W from Allen	WBT 19	21	23	22	17	22	17	23	26	24	21
Elizabeth W turning N on Oxford	WBR 10	15	27	19	12	23	21	29	23	19	16