

School Traffic

Judson International School traffic is directed into & out of the campus along Elizabeth.

- Students are dropped-off and picked-up within the campus parking lot which is accessed from Elizabeth Street.



- At our request, parking is prohibited on Elizabeth Street from 7-8 am. Traffic arrives and departs via Elizabeth and Hill Streets.



Parking Lots

- The parking lots have all been restriped in the last few years and some will be restriped again soon.
- To minimize neighborhood traffic & on-street parking, parking lots and/or spaces are assigned.
- The current total of 343 parking spaces in 5 campus parking lots will soon be increased to 440 spaces in 6 lots.
- To reduce parking on neighborhood streets on Sunday mornings, we have assigned specific lots to campus churches.
- On Sundays, the U S Center for World Mission makes all 66 spaces in their lot available, making a total of 409 (soon to be 506).



Many Staff & Students Live On Or Near Campus

With the exception of the elementary schools on campus, there is very little vehicular traffic related to students.

- Most of the other students live on campus or in WCIU owned residences within the immediate neighborhood.
- Most of the staff of WCIU and participating organizations arrive after the morning rush of students and depart after the afternoon pick-up of students.
- About 40% of the staff live on campus or in the immediate neighborhood and do not add to the vehicular traffic or parking.

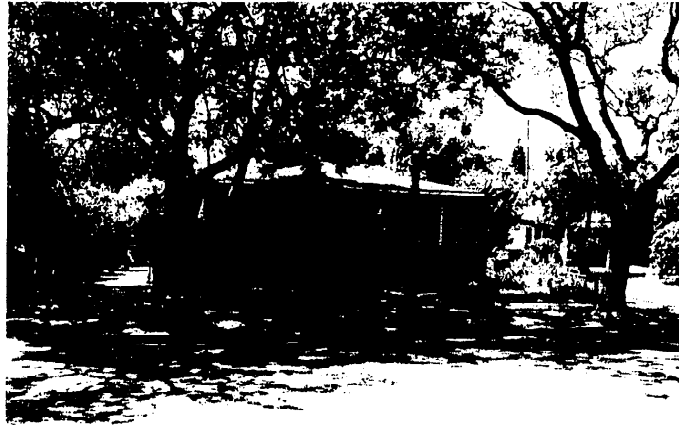

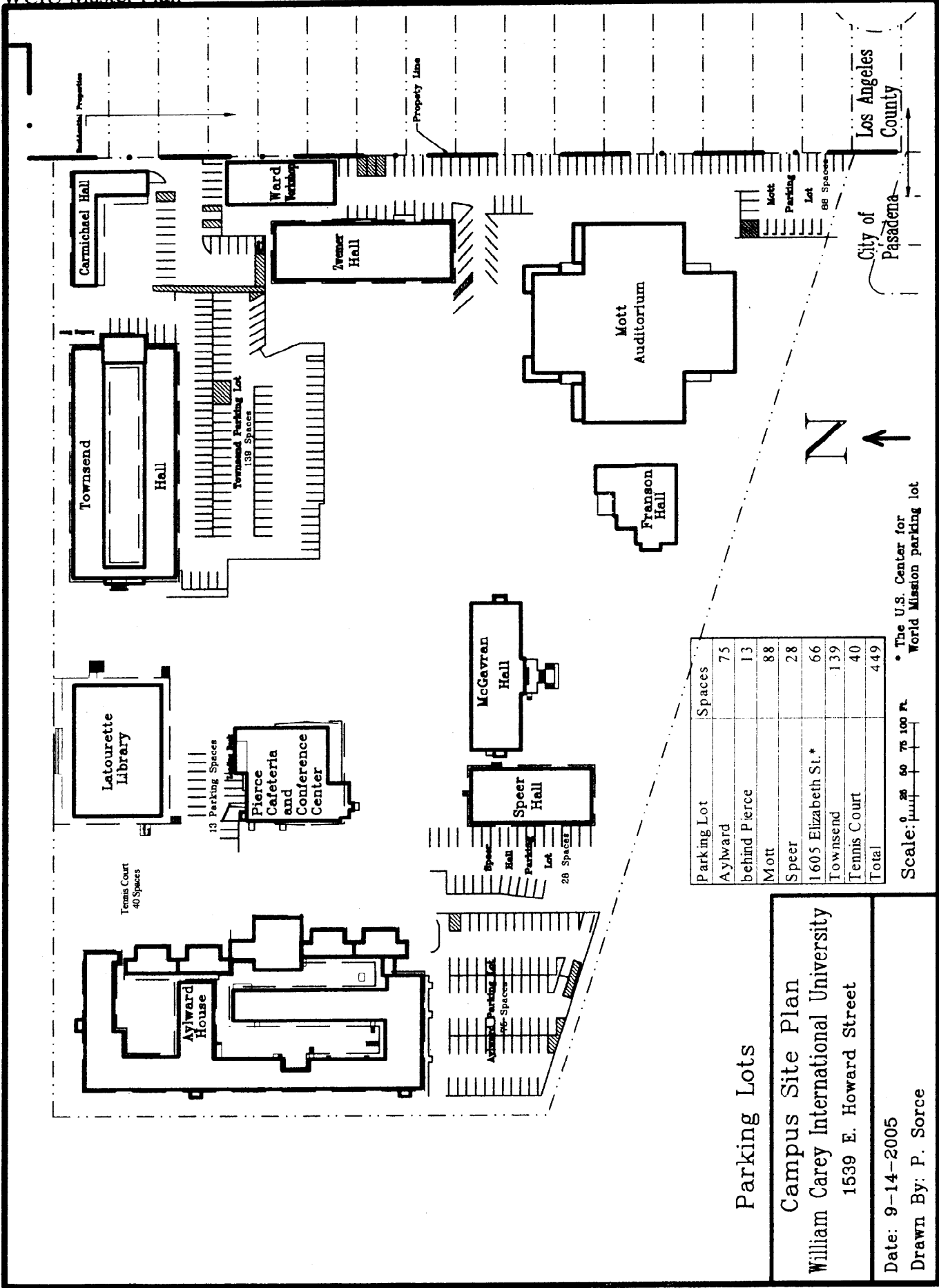

Parking Lots

Campus Site Plan
 William Carey International University
 1539 E. Howard Street

Date: 9-14-2005
 Drawn By: P. Sorce

Parking Lot	Spaces
Aylward	75
behind Pierce	13
Mott	88
Speer	28
1605 Elizabeth St.*	66
Townsend	139
Tennis Court	40
Total	449

Scale: 0 25 50 75 100 Ft. * The U.S. Center for World Mission parking lot

Volunteers Augment Our Staff

- Some volunteers live within commuting distance and serve long-term, part-time.
 - Many of the major maintenance projects on campus buildings and off-campus housing have been accomplished through the use of volunteers.
 - Various office tasks are handled by faithful volunteers.
- Some volunteers come for short periods and fill project needs.
 - some stay in our guest housing
 - others come in their own motor homes or 5th wheel RVs

RV Parking & Hook-ups

- Around 1985, the City granted a Conditional Use Permit to park up to ten RVs on campus.
 - We have provided full hook-ups (water, electricity and sewer).
 - These hook-ups are located at the south edge of the central campus parking lot.
- The City Health Department has verified that we properly installed the sewer line.
 - It connects these hook-ups to the sewer line that runs through the campus
 - and is not connected to the storm drain.



The campus is designed to be an automobile-free pedestrian-circulation system.

- Once on the campus, students, staff and/or guests do not need to cross streets to walk between buildings.
- On campus vehicular traffic is limited to the parking lots.
- A site plan is included.

The existing open spaces of the campus shall be preserved for the life of this Master Plan, with the exception that minor alterations to the size and design of existing open spaces may occur to accommodate alterations and additions to existing parking lots, if necessary.



The existing park-like appearance of the campus will be maintained for the safety and enjoyment of students, staff, guests & neighbors.

- WCIU does not discourage neighbors from enjoying the park-like setting.
- However, building interiors and sports facilities are limited to students, staff and guests.

Landscaping is generally well established at the residential streets bordering the campus.

- Existing landscaping and street trees in these areas shall be maintained in good condition and improved as required.

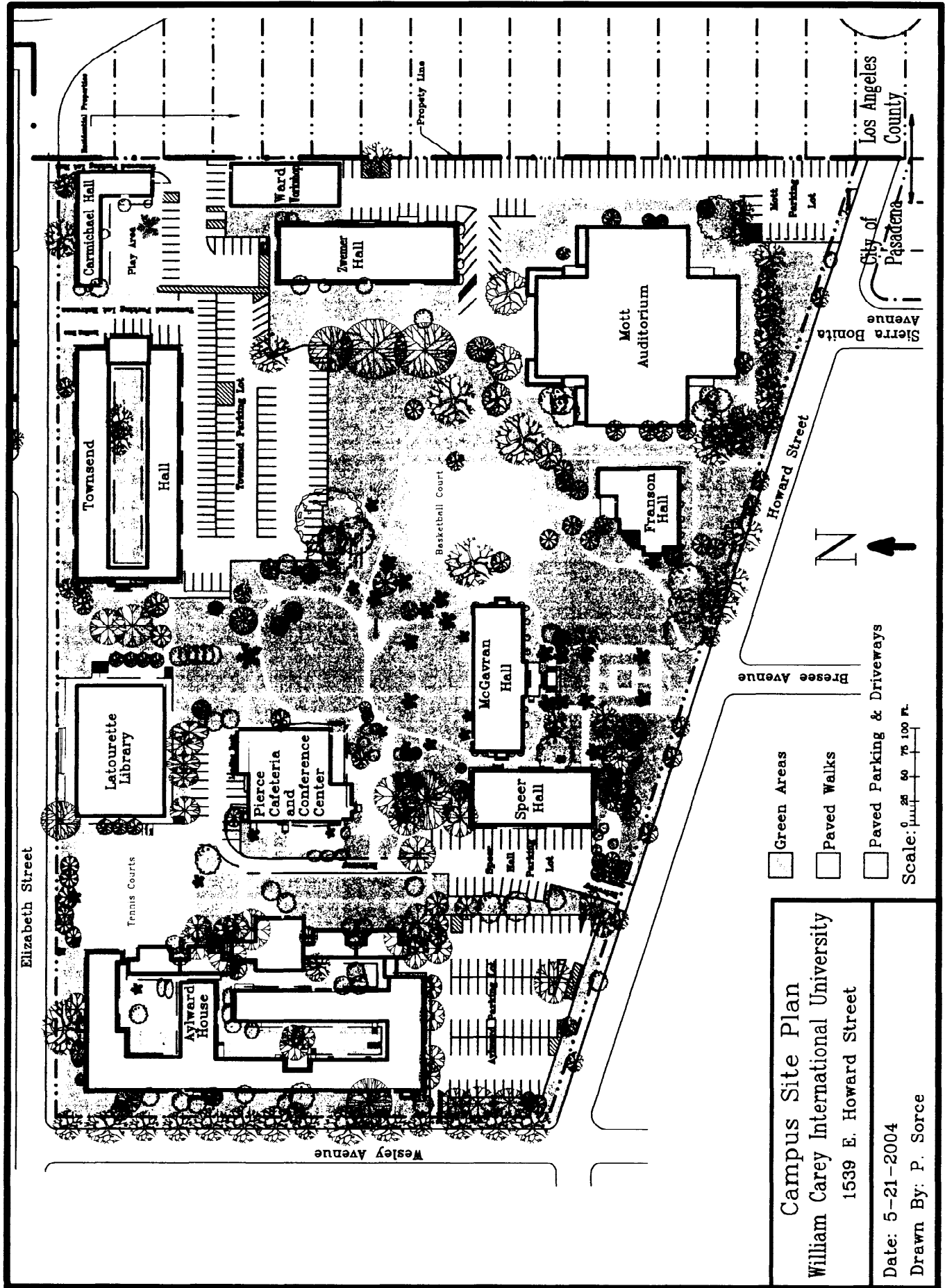

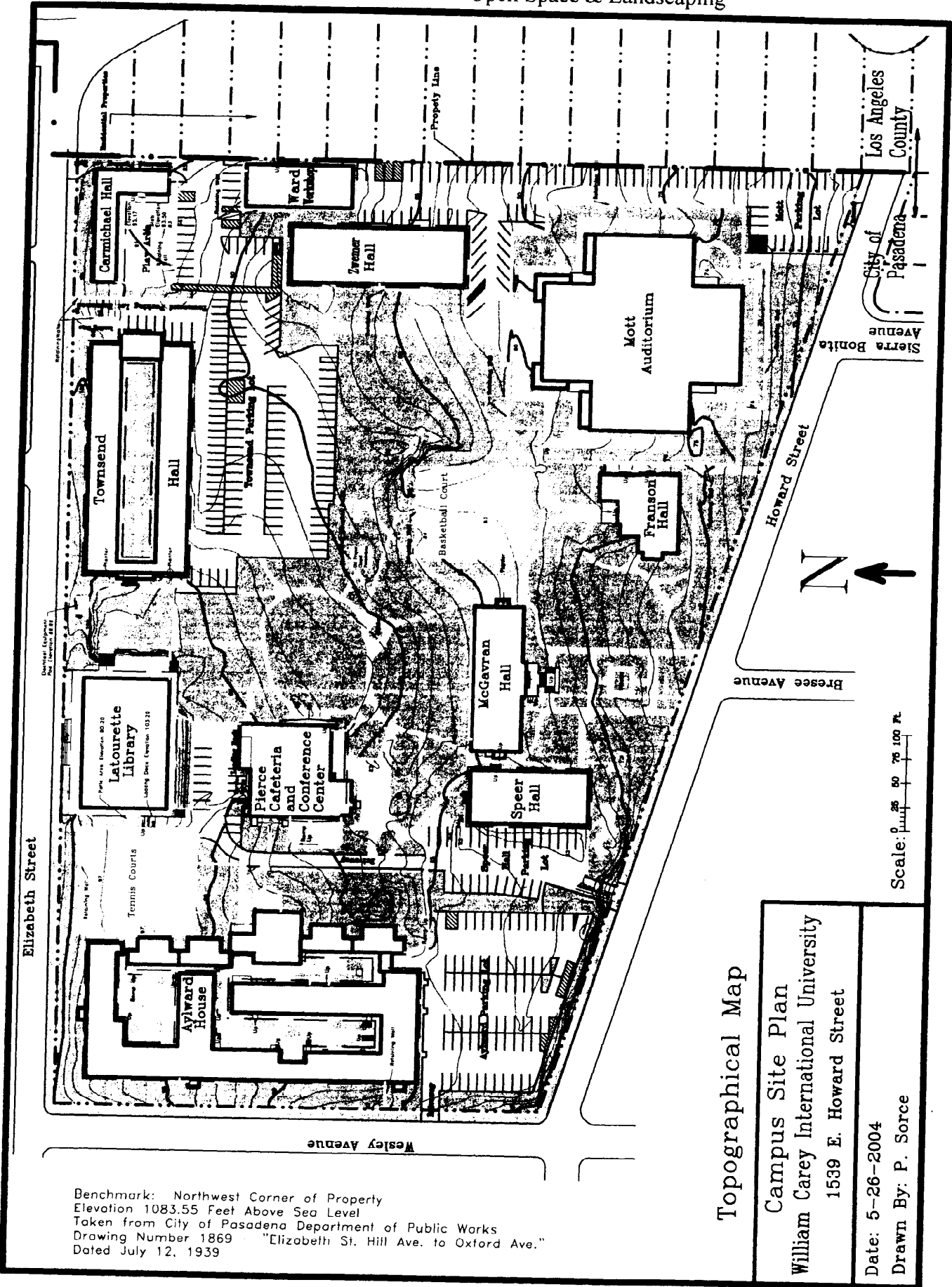

Benchmark: Northwest Corner of Property
 Elevation 1083.55 Feet Above Sea Level
 Taken from City of Pasadena Department of Public Works
 Drawing Number 1869 "Elizabeth St. Hill Ave. to Oxford Ave."
 Dated July 12, 1939

Topographical Map

Campus Site Plan
 William Carey International University
 1539 E. Howard Street
 Date: 5-26-2004
 Drawn By: P. Sorce

Perimeter Signs

We have some signs on the perimeter of the campus to identify the campus as William Carey International University.

Organization Signs

Some of the departments and participating organizations have signs on the building near their entrance or prominently on or near the building to guide visitors.

Building Signs

Discussions are underway about putting the names of each building on or near the building to direct visitors or conference participants.

Campus Directories

We have had a campus directory located near the sidewalks on Howard Street and Elizabeth Street and may do so again.

Sunday Church Signs

WCIU permits campus churches to display signs on Sundays to direct people to their services.

Dimensions of Signs

- The size of a sign is determined by the distance from which the sign needs to be read and the information to be conveyed.
 - Sign lettering on the perimeter signs is designed to be read from 100'-150'.
 - Lettering is larger on signs which need to be seen from across the campus, but which are generally not visible from the street.
- The shape of the sign is dependant on its location.

Site Plan

The following site plan identifies the location and approximate size of current or future signs.

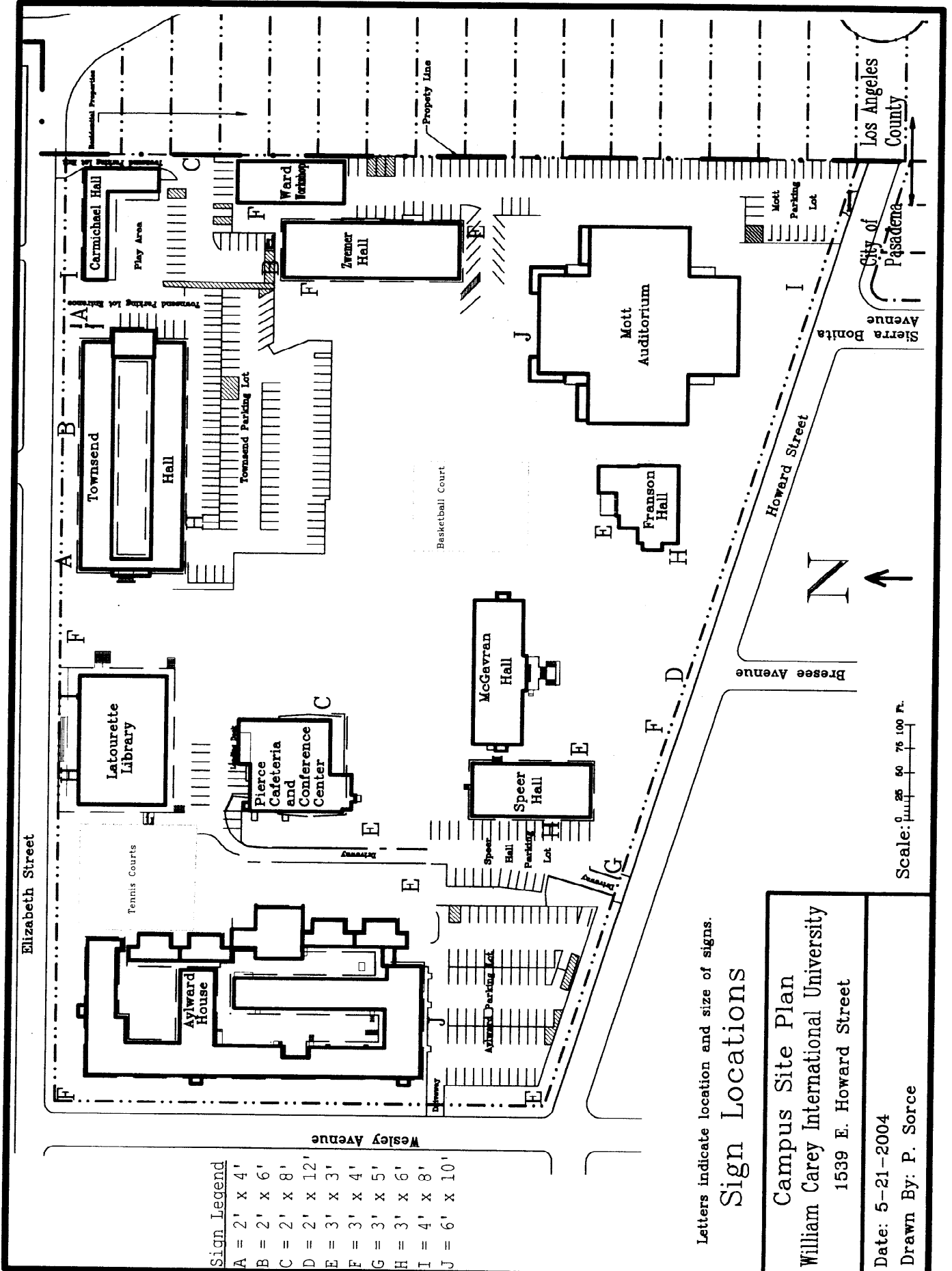

Sign Legend

A	=	2' x 4'
B	=	2' x 6'
C	=	2' x 8'
D	=	2' x 12'
E	=	3' x 3'
F	=	3' x 4'
G	=	3' x 5'
H	=	3' x 6'
I	=	4' x 8'
J	=	6' x 10'

Letters indicate location and size of signs.

Sign Locations

Campus Site Plan
 William Carey International University
 1539 E. Howard Street

Date: 5-21-2004
 Drawn By: P. Sorce



Major Events

Occasionally major conferences are held on campus, which bring traffic and parking concerns.

- Such conferences are held evenings and weekends when campus parking lots are otherwise empty.
- Parking attendants direct conferees to designated parking areas to reduce the impact of traffic and parking in the neighborhood.
- In addition, WCIU notifies neighbors via letter in advance of such conferences and includes phone numbers to call to report any driveway blocking.
- The following are events that have been held on campus before and that we expect to happen again.
- There may be others that we are not yet aware of, but which may be similar in size and duration.

Worship Symposium

Living Waters Church located on Altadena Drive holds a worship symposium each January.

- About 1000-1500 people attend the evening and weekend sessions of the symposium.
- During the day on Thursday & Friday, attendance is only 200-300.

Harvest Rock Church Conferences

Harvest Rock Church and ministries conduct two conferences a year.

- One in November and the other in January
- These draw about 1500 conferees each.
- The conferences run Wednesday through Sunday.
- Daytime attendance Wednesday-Friday is usually less than 300.

Pow Wow

Native Americans have held pow wows once a year.

- These are arts & crafts type events.
- Throughout the day, up to 2000 visitors come and go.
- Only a few hundred are on the campus at any one time.

Additional conferences and seminars that are smaller in size

Below is a list of the types of meetings that take place on campus that are smaller in size. This list is not exhaustive as these events are scheduled throughout various times of the year.

- Point Loma Nazarene College Anniversary Open House/Tour
- Maranatha Plays, Back-to-school night, open house etc
- Judson Plays, Back-to-school night, open house etc.

- USCWM Conferences, anniversary celebrations, open houses, retreats etc.
- WCIU weddings, wedding receptions, funerals, memorial services etc.
- Graduation Ceremonies (all schools)
- Church picnics
- Special prayer meetings. From time to time the churches call special prayer meetings. Relatively few in number and are sometimes all night prayer meetings inside facilities.
- School fundraising car washes, rummage sales etc (usually Saturdays)
- Various organization annual seminars.
- Neighborhood kids after-school basketball games
- Small concerts

Volunteers Augment Our Staff

- Some volunteers live within commuting distance and serve long-term, part-time.
 - Many of the major maintenance projects on campus buildings and off-campus housing have been accomplished through the use of volunteers.
 - Various office tasks are handled by faithful volunteers.
- Some volunteers come for short periods and fill project needs.
 - some stay in our guest housing
 - others come in their own motor homes or 5th wheel RVs

RV Parking & Hook-ups

- Around 1985, the City granted a Conditional Use Permit to park up to ten RVs on campus.
 - We have provided full hook-ups (water, electricity and sewer).
 - These hook-ups are located at the south edge of the central campus parking lot.
- The City Health Department has verified that we properly installed the sewer line.
 - It connects these hook-ups to the sewer line that runs through the campus
 - and is not connected to the storm drain.



The Mobile Missionary Assistance Program

MMAAP has been the mainstay of our maintenance volunteer force.

- They provide teams of maintenance volunteers every year.
- MMAAP is an organization that sends teams of retired couples to volunteer at other non-profit organizations all over North America.
- Each team of five to ten couples comes for a three-week project.
- The value of their volunteer labor over the years is in the millions of dollars.
- WCIU obtains the building permits and provides the materials and the MMAAP volunteers provide the labor and tools.
- MMAAP provides teams during the six months of the year when retirees like to come to California.

Other Volunteers With RVs

At other times of the year, other volunteers who come with their RV may be here for longer periods.

- Some have specific skills that are needed for special projects.
- Retired programmers, electricians, college professors and real estate appraisers are some of the volunteers who bring their RV when they come.
- These RV parking hook-ups are not for long-term volunteers or staff.

The campus is designed to be an automobile-free pedestrian-circulation system.

- Once on the campus, students, staff and/or guests do not need to cross streets to walk between buildings.
- On campus vehicular traffic is limited to the parking lots.
- A site plan is included.

The existing open spaces of the campus shall be preserved for the life of this Master Plan, with the exception that minor alterations to the size and design of existing open spaces may occur to accommodate alterations and additions to existing parking lots, if necessary.



The existing park-like appearance of the campus will be maintained for the safety and enjoyment of students, staff, guests & neighbors.

- WCIU does not discourage neighbors from enjoying the park-like setting.
- However, building interiors and sports facilities are limited to students, staff and guests.

Landscaping is generally well established at the residential streets bordering the campus.

- Existing landscaping and street trees in these areas shall be maintained in good condition and improved as required.

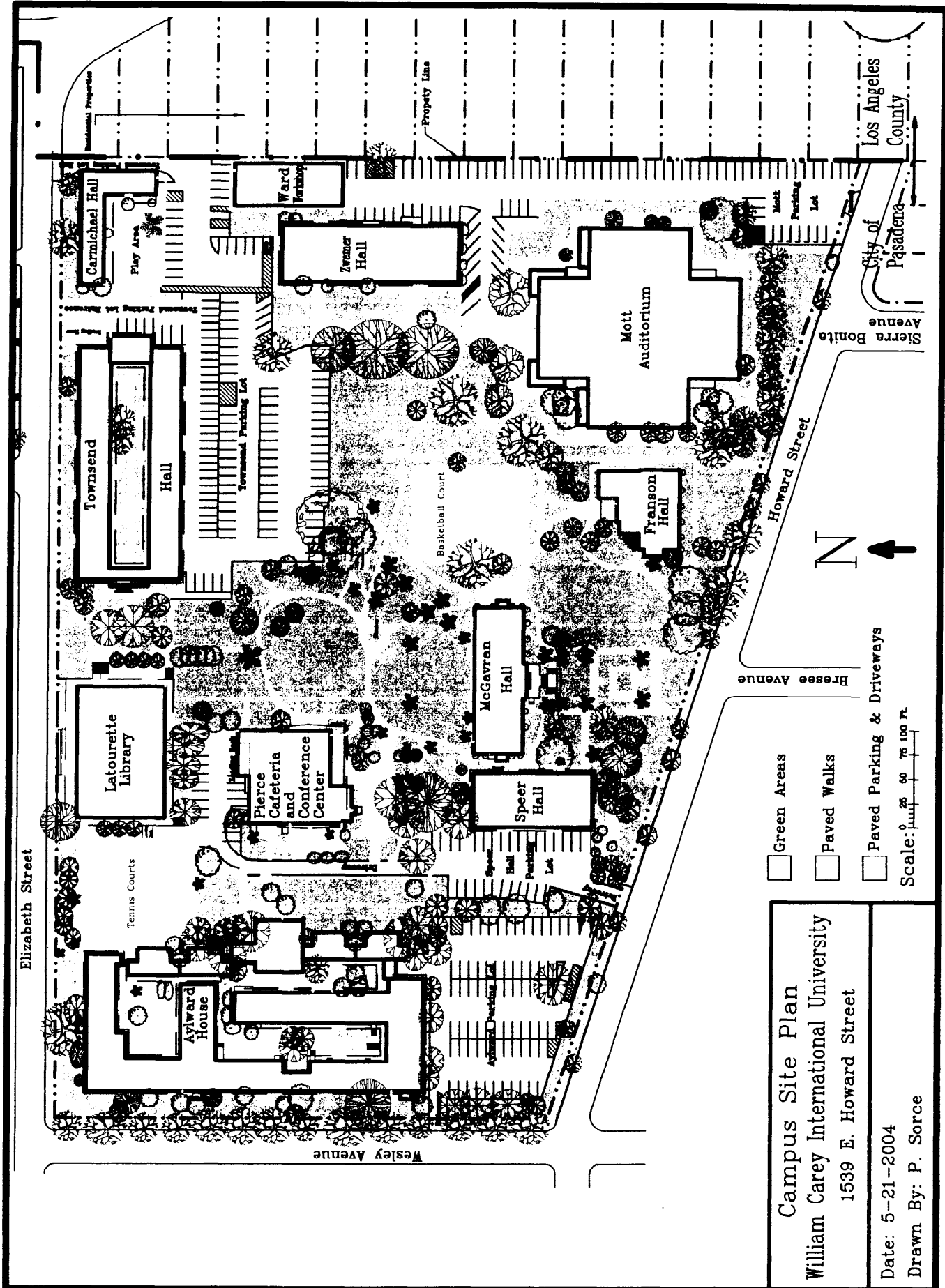

Campus Site Plan
William Carey International University
 1539 E. Howard Street
 Date: 5-21-2004
 Drawn By: P. Sorce

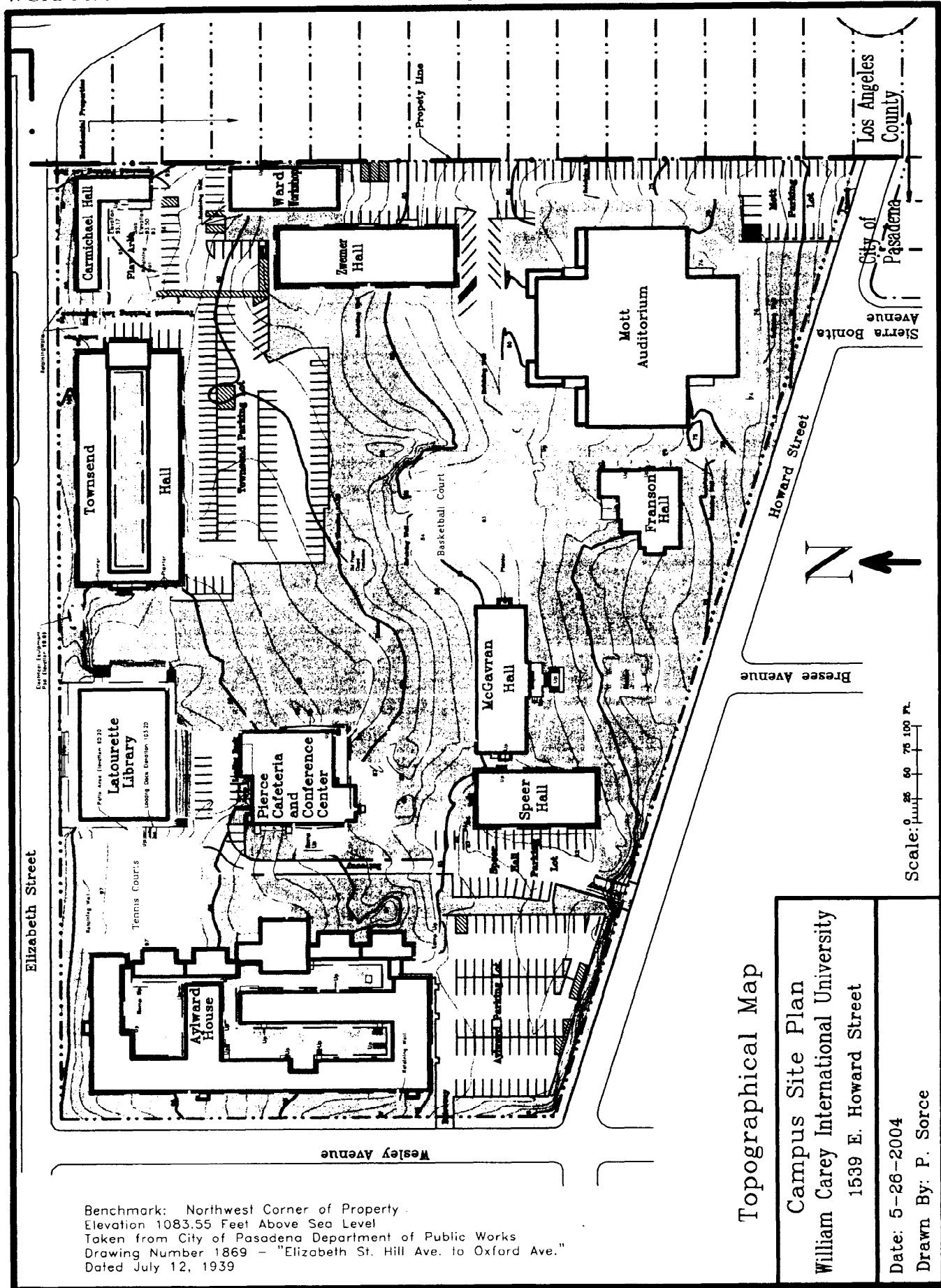

Benchmark: Northwest Corner of Property
 Elevation 1083.55 Feet Above Sea Level
 Taken from City of Pasadena Department of Public Works
 Drawing Number 1869 - "Elizabeth St. Hill Ave. to Oxford Ave."
 Dated July 12, 1939

Topographical Map

Campus Site Plan
 William Carey International University
 1539 E. Howard Street
 Date: 5-26-2004
 Drawn By: P. Sorce

Scale: 0 25 50 75 100 Ft.



City of Pasadena
 Los Angeles County
 Sierra Bonita Avenue
 Howard Street
 Breese Avenue

Perimeter Signs

We have some signs on the perimeter of the campus to identify the campus as William Carey International University.

Organization Signs

Some of the departments and participating organizations have signs on the building near their entrance or prominently on or near the building to guide visitors.

Building Signs

Discussions are underway about putting the names of each building on or near the building to direct visitors or conference participants.

Campus Directories

We have had a campus directory located near the sidewalks on Howard Street and Elizabeth Street and may do so again.

Sunday Church Signs

WCIU permits campus churches to display signs on Sundays to direct people to their services.

Dimensions of Signs

- The size of a sign is determined by the distance from which the sign needs to be read and the information to be conveyed.
 - Sign lettering on the perimeter signs is designed to be read from 100'-150'.
 - Lettering is larger on signs which need to be seen from across the campus, but which are generally not visible from the street.
- The shape of the sign is dependant on its location.

Site Plan

The following site plan identifies the location and approximate size of current or future signs.

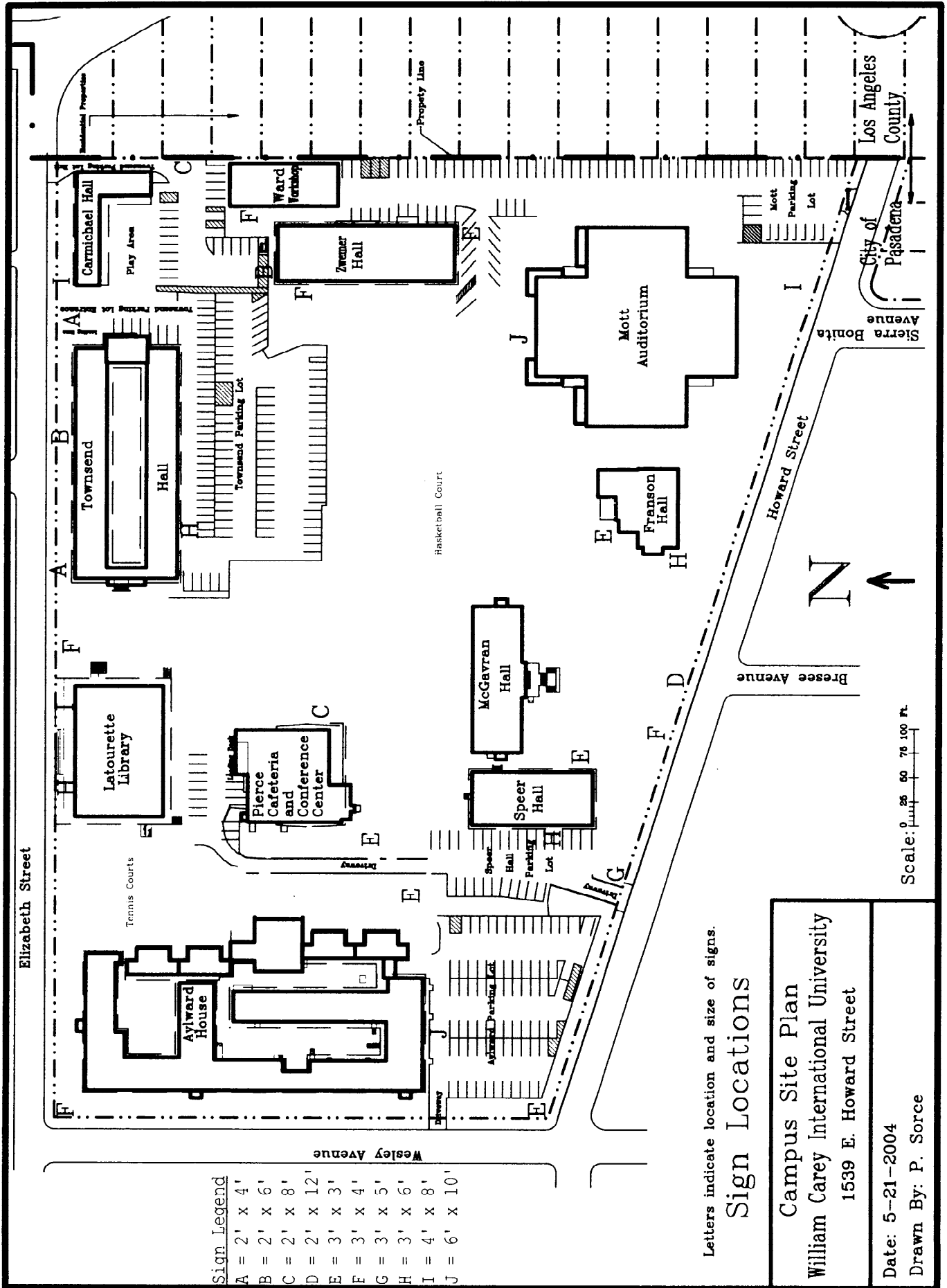

Sign Legend

A	=	2' x 4'
B	=	2' x 6'
C	=	2' x 8'
D	=	2' x 12'
E	=	3' x 3'
F	=	3' x 4'
G	=	3' x 5'
H	=	3' x 6'
I	=	4' x 8'
J	=	6' x 10'

Letters indicate location and size of signs.

Sign Locations

<p>Campus Site Plan William Carey International University 1539 E. Howard Street</p>	
<p>Date: 5-21-2004 Drawn By: P. Sorce</p>	<p>Scale: 0 25 50 75 100 ft.</p>

Major Events

Occasionally major conferences are held on campus, which bring traffic and parking concerns.

- Such conferences are held evenings and weekends when campus parking lots are otherwise empty.
- Parking attendants direct conferees to designated parking areas to reduce the impact of traffic and parking in the neighborhood.
- In addition, WCIU notifies neighbors via letter in advance of such conferences and includes phone numbers to call to report any driveway blocking.
- The following are events that have been held on campus before and that we expect to happen again.
- There may be others that we are not yet aware of, but which may be similar in size and duration.

Worship Symposium

Living Waters Church located on Altadena Drive holds a worship symposium each January.

- About 1000-1500 people attend the evening and weekend sessions of the symposium.
- During the day on Thursday & Friday, attendance is only 200-300.

Harvest Rock Church Conferences

Harvest Rock Church and ministries conduct two conferences a year.

- One in November and the other in January
- These draw about 1500 conferees each.
- The conferences run Wednesday through Sunday.
- Daytime attendance Wednesday-Friday is usually less than 300.

Pow Wow

Native Americans have held pow wows once a year.

- These are arts & crafts type events.
- Throughout the day, up to 2000 visitors come and go.
- Only a few hundred are on the campus at any one time.

Additional conferences and seminars that are smaller in size

Below is a list of the types of meetings that take place on campus that are smaller in size. This list is not exhaustive as these events are scheduled throughout various times of the year.

- Point Loma Nazarene College Anniversary Open House/Tour
- Maranatha Plays, Back-to-school night, open house etc
- Judson Plays, Back-to-school night, open house etc.

- USCWM Conferences, anniversary celebrations, open houses, retreats etc.
- WCIU weddings, wedding receptions, funerals, memorial services etc.
- Graduation Ceremonies (all schools)
- Church picnics
- Special prayer meetings. From time to time the churches call special prayer meetings. Relatively few in number and are sometimes all night prayer meetings inside facilities.
- School fundraising car washes, rummage sales etc (usually Saturdays)
- Various organization annual seminars.
- Neighborhood kids after-school basketball games
- Small concerts

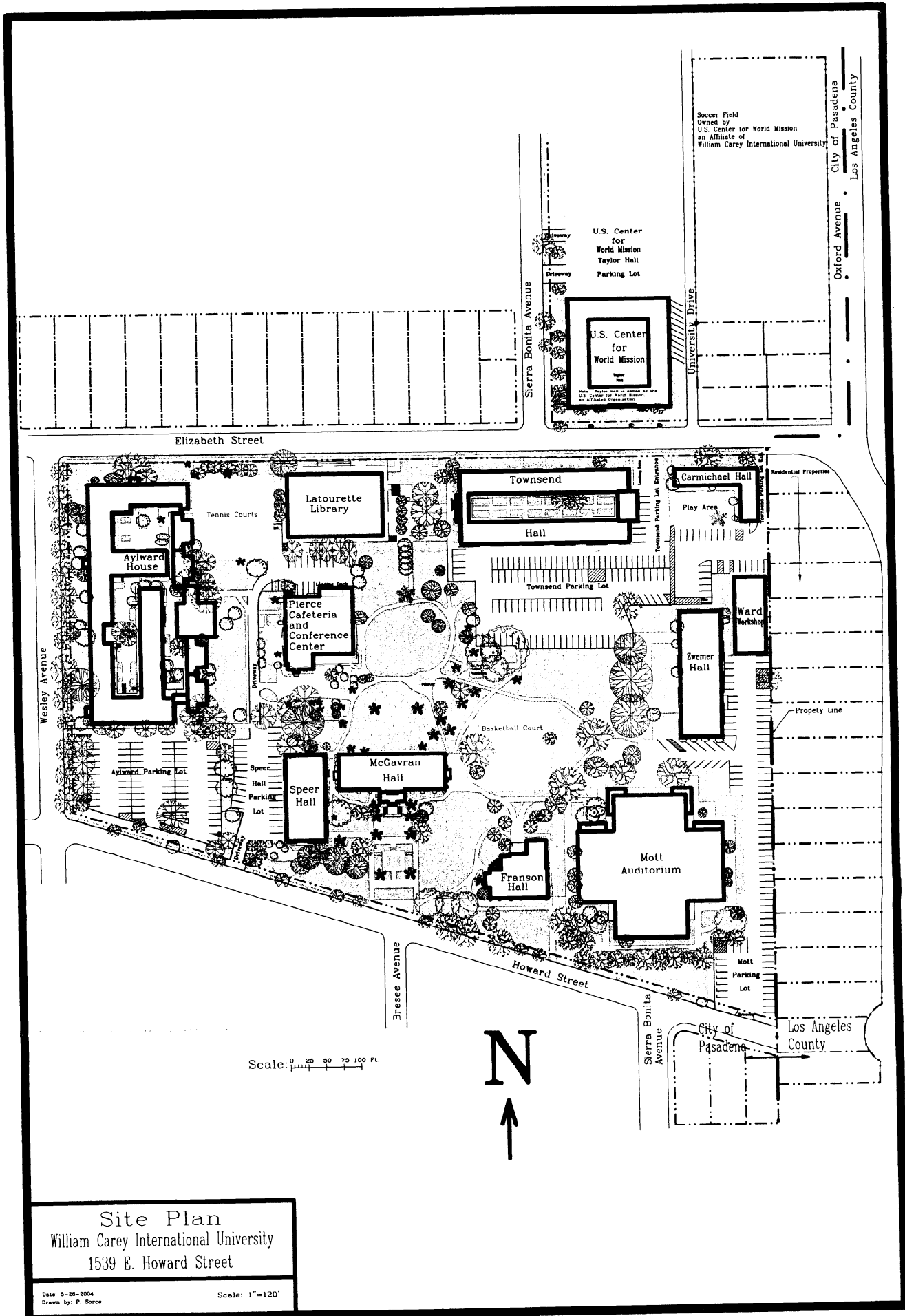

Site Plan
 William Carey International University
 1539 E. Howard Street

Date: 5-28-2004
 Drawn by: P. Sorce

Scale: 1"=120'

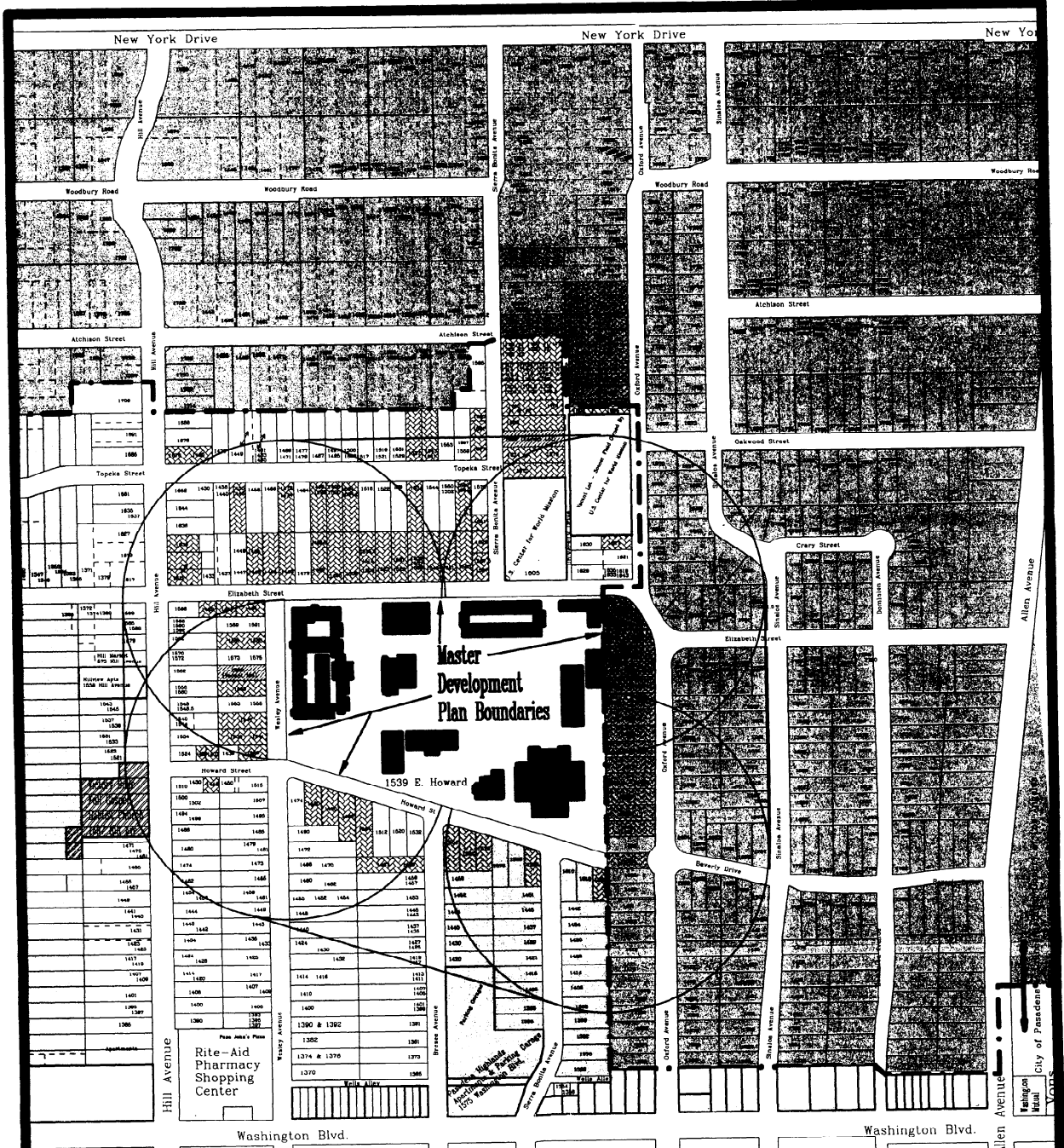

William Carey International University
 1539 E. Howard Street
 Master Plan Boundaries & Adjacent Uses
 Drawn by F. Sorce
 Date: 0-07-2004

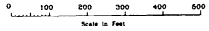

Legend

Pasadena Zones

- RM-12
- RS-6
- CL

500 Feet Radius from Master Plan Boundary

City Limit Lines

- Master Plan Area
- WCIU Off-Campus Housing
- Unincorporated LA County Residential Properties
- Vacant Lots Owned by WCIU