

Ordinance Fact Sheet

TO: CITY COUNCIL **DATE:** JUNE 19, 2006

FROM: CITY ATTORNEY

SUBJECT: AN ORDINANCE AMENDING THE OFFICIAL ZONING MAP OF THE CITY OF PASADENA TO REDUCE THE DENSITY (TO RM-12) AT THE NORTH AND MOUNTAIN SECTIONS OF LOS ROBLES/ADENA

TITLE OF PROPOSED ORDINANCE

AN ORDINANCE OF THE CITY OF PASADENA AMENDING THE OFFICIAL ZONING MAP OF THE CITY OF PASADENA ESTABLISHED BY TITLE 17, CHAPTER 20, SECTION 17.20.020 OF THE PASADENA MUNICIPAL CODE TO CHANGE THE DESIGNATION FOR THE PROPERTIES LOCATED WITHIN THE NORTH SECTION AND MOUNTAIN SECTION OF THE LOS ROBLES/ADENA STUDY AREA TO RM-12

PURPOSE OF ORDINANCE

This ordinance implements and codifies the Zoning Map amendments approved by the City Council on May 8, 2006, to reduce the allowed development density in two of the Los Robles/Adena study areas, as depicted on the map attached to the full text ordinance.

REASON WHY LEGISLATION IS NEEDED

This legislation is needed to further the City's General Plan goal "to preserve the character, scale and quality of established residential neighborhoods." This legislation would eliminate the conflict between the current higher density zoning on the affected properties, and abutting, lower density zones.

PROGRAMS, DEPARTMENTS OR GROUPS AFFECTED

The Planning and Development Department will implement the proposed ordinance.

06/21/2006
MEETING OF ~~06/19/2006~~
AGENDA ITEM NO. 9.A.3.

FISCAL IMPACT

There will not be an immediate fiscal impact as a result of this amendment to the Zoning Code. Permitting fees will be collected from any future development proposed on the properties impacted.

ENVIRONMENTAL DETERMINATION

A Negative Declaration was prepared and approved for the project in conformance with the requirements of the California Environmental Quality Act.

Respectfully submitted,

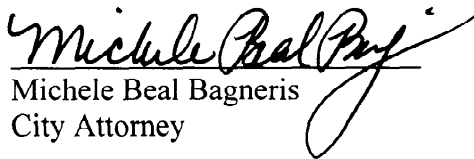

Michele Beal Bagneris
City Attorney

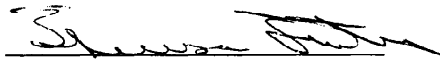
Prepared by:

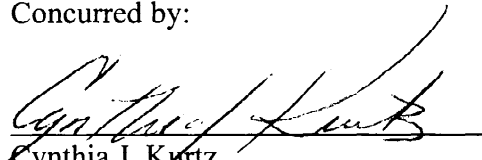

Theresa E. Fuentes
Deputy City Attorney

Concurred by:



Cynthia J. Kurtz
City Manager

Introduced by _____

ORDINANCE NO. _____

AN ORDINANCE OF THE CITY OF PASADENA AMENDING THE OFFICIAL ZONING MAP OF THE CITY OF PASADENA ESTABLISHED BY TITLE 17, CHAPTER 20, SECTION 17.20.020 OF THE PASADENA MUNICIPAL CODE TO CHANGE THE DESIGNATION FOR THE PROPERTIES LOCATED WITHIN THE NORTH SECTION AND MOUNTAIN SECTION OF THE LOS ROBLES/ADENA STUDY AREA TO RM-12

The People of the City of Pasadena ordain as follows:

SECTION 1. The official zoning map of the City of Pasadena as established by Title 17, Chapter 20, Section 17.20.020 of the City of Pasadena Municipal Code is amended by modifying the boundaries of certain zoning districts established therein as follows:

By reclassifying from RM-16 (Multi-Family Residential – City of Gardens) to RM-12 (Multi-Family Residential – Two-Units Per Lot) the properties located in the Northern Section of the study area, shown on the map entitled “Los Robles/Adena Zone Change Study” dated April 2006, attached hereto as Exhibit A and incorporated herein by this reference.

And by reclassifying from RM-32 (Multi-Family Residential – City of Gardens) to RM-12 (Multi-Family Residential – Two Units Per Lot) the properties in the Mountain Section of the study area, shown on the map entitled “Los Robles/Adena Zone Change Study” dated April, 2006, attached hereto as Exhibit A and incorporated herein by this reference.

SECTION 3. The City Clerk shall certify the adoption of this ordinance and shall cause this ordinance to be published in full text.

SECTION 4. This ordinance shall take effect 30 days from its publication.

Signed and approved this _____ day of _____, 2006.

Bill Bogaard
Mayor of the City of Pasadena

I HEREBY CERTIFY that the foregoing ordinance was adopted by the City Council of the City of Pasadena at its meeting held _____, 2006 by the following vote:

AYES:

NOES:

ABSENT:

ABSTAIN:

Published:

Jane L. Rodriguez, CMC
City Clerk

APPROVED AS TO FORM:



Theresa Fuentes,
Deputy City Attorney

Los Robles / Adena Zone Change Study

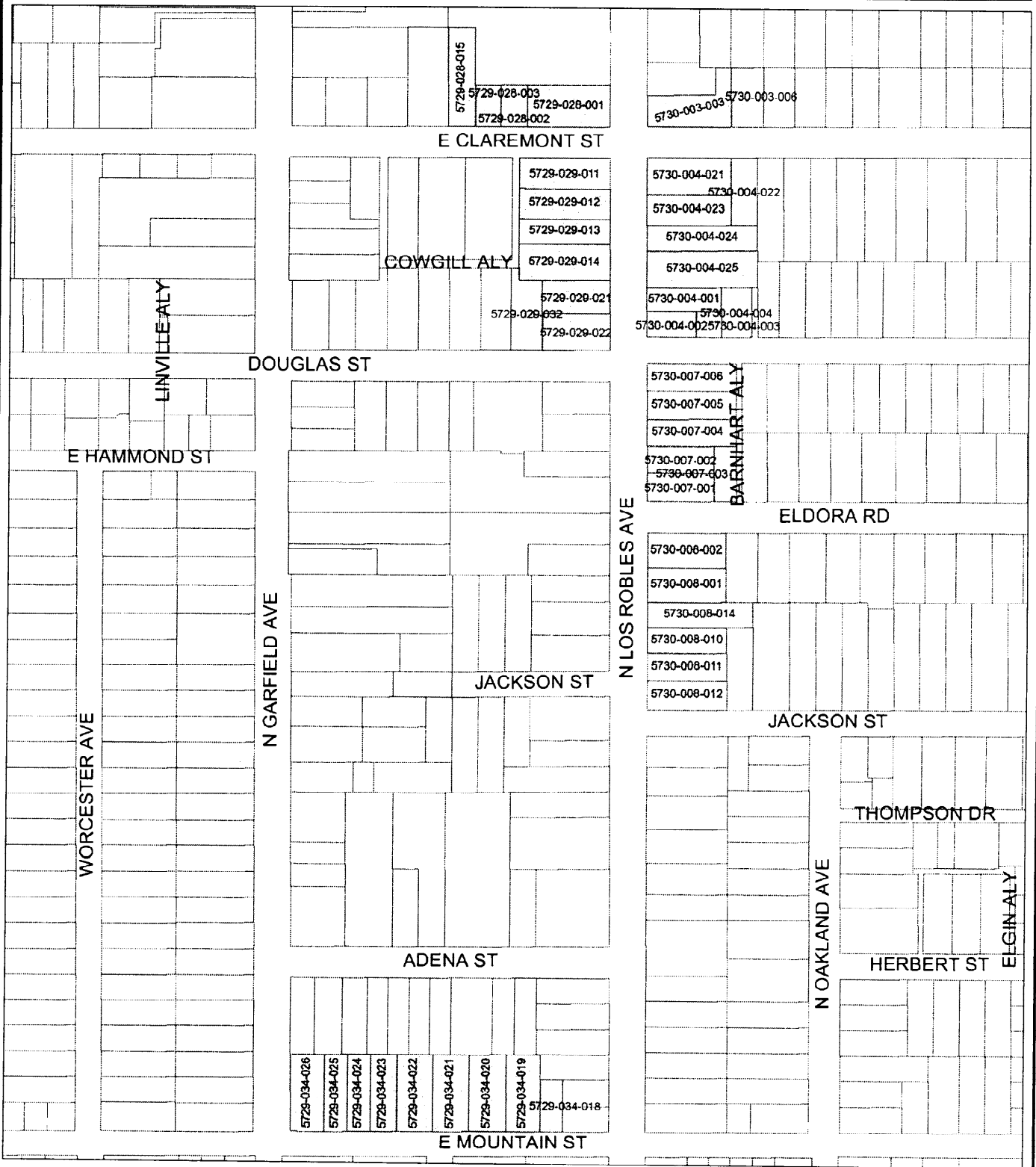

The maps and associated data are provided without warranty of any kind. Any resale of this information is prohibited. Copyright © 2001, City of Pasadena.

0 150 300 600 Feet

Legend

- NO ZONE CHANGE
- CHANGE TO RM-12

Coordinate System
State Plane California Zone V
FIPS 405 (Feet), NAD 1983