

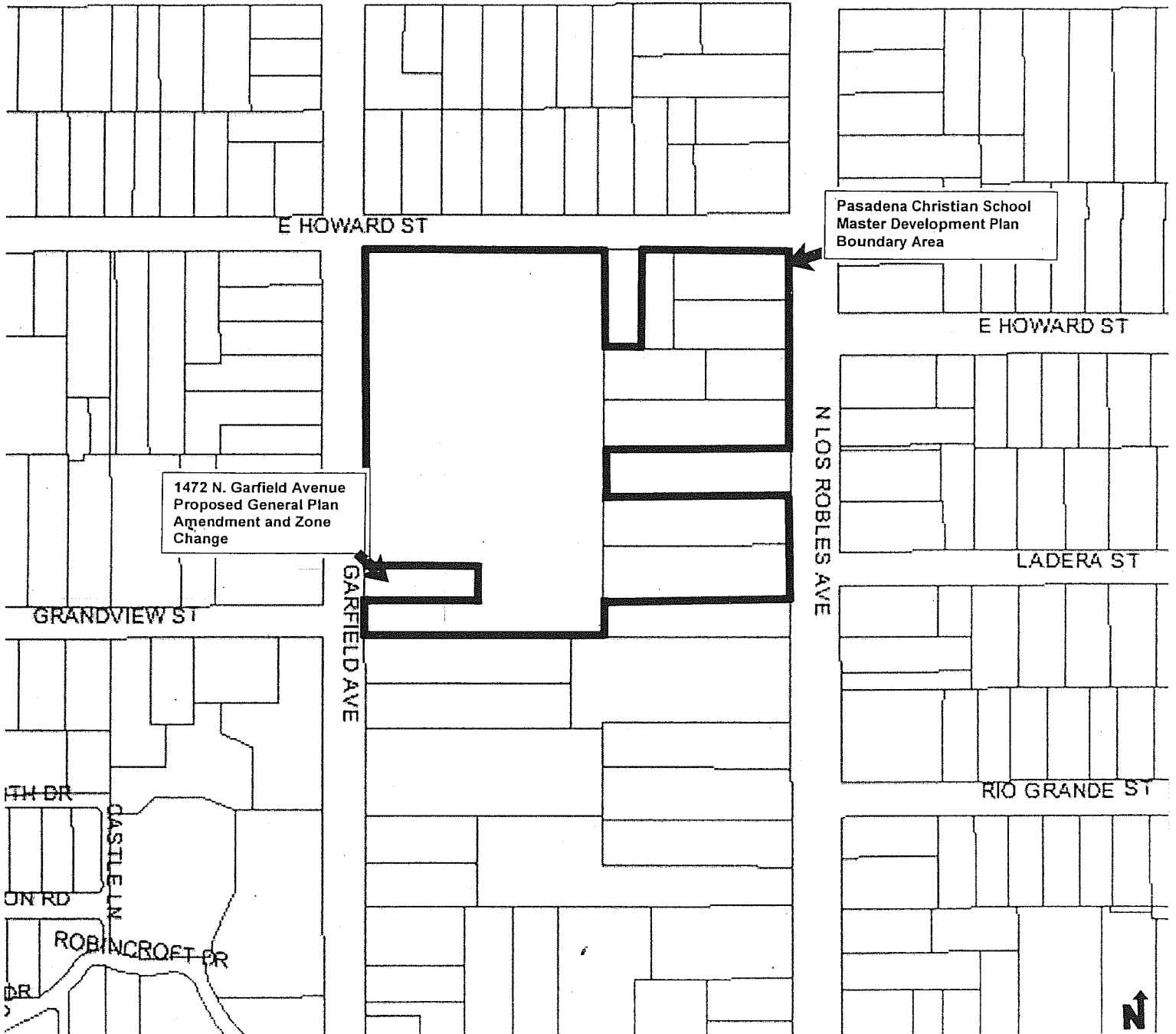

**Master Development Plan Amendment for
Pasadena Christian School at 1515 N. Los Robles Avenue
and General Plan Amendment and Zone Change
at 1472 N. Garfield Avenue**



1472 N. Garfield Avenue
Proposed General Plan
Amendment and Zone
Change

Pasadena Christian School
Master Development Plan
Boundary Area

E HOWARD ST

E HOWARD ST

N LOS ROBLES AVE

LADERA ST

GRANDVIEW ST

GARFIELD AVE

RIO GRANDE ST

