

ATTACHMENT A:

Map of Proposed Landmark District

Potential Arden Road Landmark District

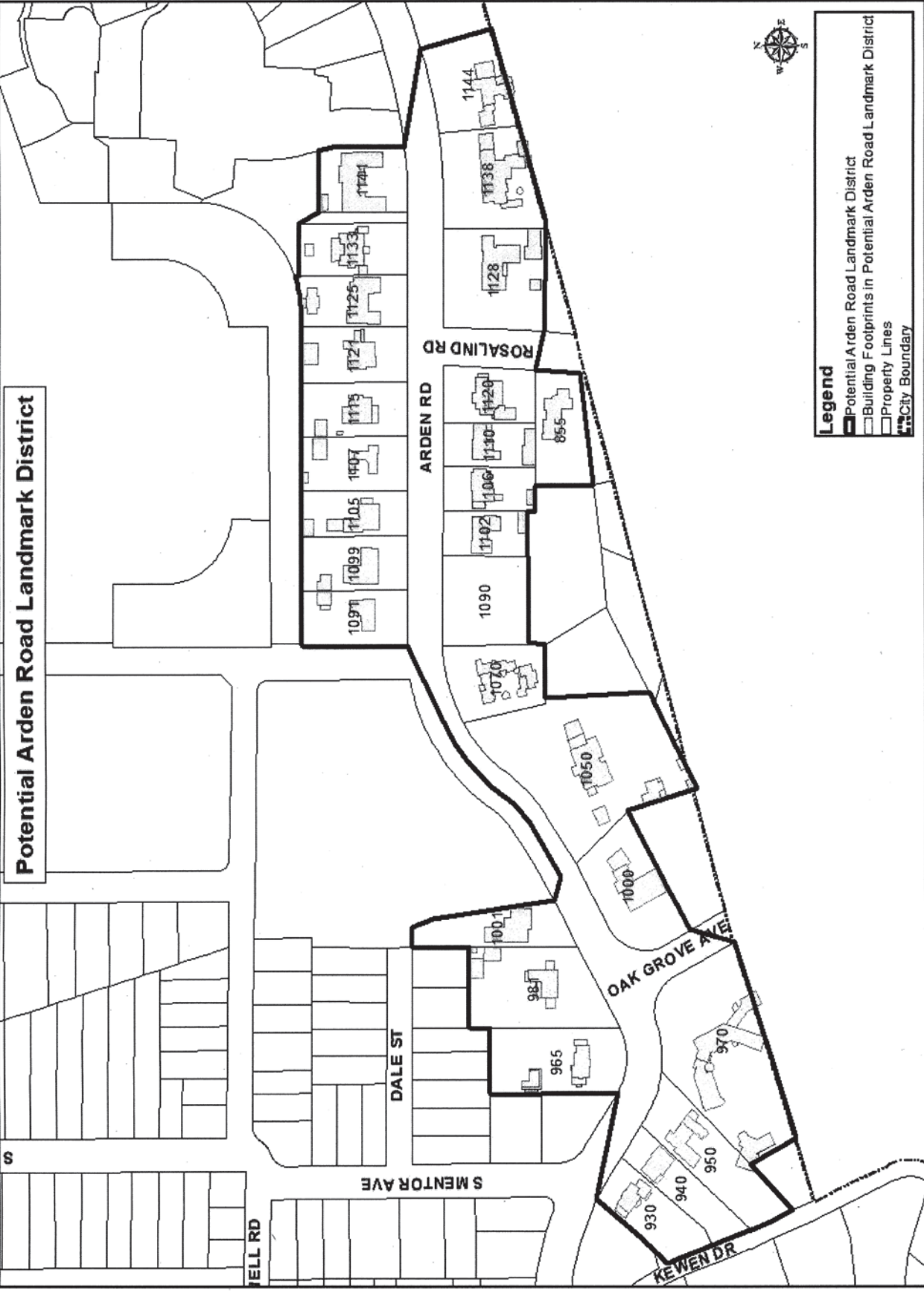

Legend

- Potential Arden Road Landmark District
- Building Footprints in Potential Arden Road Landmark District
- Property Lines
- - - Lines
- ... City Boundary

ATTACHMENT B:
Inventory of Properties

Arden Road Landmark District Inventory of Properties

Full Address	Year	Architect	Builder	Original Owner	Style	Alterations	C/NC	Notes
930 ARDEN RD	1924	Wallace Neff	J.C. Clemence	Mr. L. Mac Blankenhorn	Neoclassical Revival		C	
940 ARDEN RD	1925	Wallace Neff	A.J. Spindt	Lawrence Macomber	Spanish Colonial Revival		C	
950 ARDEN RD	1928	Wallace Neff	Karl J. Miller	Mrs. Vernon Goodwin	Spanish Colonial Revival		C	
965 ARDEN RD	1923	L.C. Brockway	C.G. Wopschall	Mrs. A.W. Longray	Italian Renaissance Revival		C	
970 ARDEN RD	1929	Garret Van Pelt, Jr.		D.W. Norris	Tudor	Substantial side and rear additions made in 2000 and approved by DHP	C	Architect per Architectural Digest; Charles Gibbs Adams Landscape Architect
981 ARDEN RD	1922	G. Lawrence Stimson	G. Lawrence Stimson	M.B. Hess	Colonial Revival		C	
1000 ARDEN RD	1957	Fred C. Richardson		Mrs. Esther J. Richardson	Modern Ranch		NC	
1001 ARDEN RD	1952			David Lynch	Modern Ranch		NC	
1050 ARDEN RD	1912	G. Lawrence Stimson (1912); Edward M. Fowler & W.W. Warren (1930)	G. Lawrence Stimson	Joseph M. Hixon	Tudor		C	December 13, 1930 PSN article indicates substantial exterior remodel by Fowler & Warren in 1930
1070 ARDEN RD	1961	Bob Ray Offenhauser		Toby Franklin Wilcox	Late Regency		NC	
1090 ARDEN RD				S.K. McNulty	Colonial Revival	West porch enclosed/expanded	NC	
1091 ARDEN RD	1918	G. Lawrence Stimson	G. Lawrence Stimson	Clifton J. Platt	Colonial Revival		C	
1099 ARDEN RD	1921	Frederick Kennedy, Jr.	Mark E. Lincoln	Dr. H.F. Laffer	Colonial Revival		C	
1102 ARDEN RD	1929	C.R. Wicks	Dr. H.F. Laffer	Dr. H.F. Laffer	Monterey Revival		C	
1105 ARDEN RD	1917	Marston & Van Pelt	Wopschall Brothers	William D. Lacey	French Eclectic		C	
1106 ARDEN RD	1929	C.R. Wicks	Dr. H.F. Laffer	Dr. H.F. Laffer	Monterey Revival		C	
1107 ARDEN RD	1927	John C. Spahr	A.B. Test	Oliver Van Ausberg	Italian Renaissance Revival		C	
1110 ARDEN RD	1928	C.R. Wicks	Dr. H.F. Laffer	Dr. H.F. Laffer	Spanish Colonial Revival		C	Moved from 590 E. Colorado St. (now Blvd.) in 1925 and altered
1115 ARDEN RD	1903	John C. Austin	J.B. Johnson	J.B. Johnson	Colonial Revival		C	
1120 ARDEN RD	1927	Everett Phipps Babcock & Robert H. Ainsworth	J.J. Brintnall	Miss Miriam Hills	French Eclectic		C	
1121 ARDEN RD	1909	John C. Austin	August C. Brandt	John C. Austin	Tudor		C	Building permit info per research form in DHP archives; Moved from 85 S. Madison Ave. in 1925 and altered
1125 ARDEN RD	1948	Theo L. Pletsch	Owen T. Reeves	Jayne H. & George Stanley Hatch		3,000 sf second story added in 1996	NC	Original permit attached to 1120
1128 ARDEN RD	1930		Dr. H.F. Laffer	Dr. H.F. Laffer	Monterey Revival		C	No architect listed on original permit; likely C.R. Wicks due to association with owner
1133 ARDEN RD	2017	Richard Krantz					NC	New house
1138 ARDEN RD	1929	Roland Coate	Ray Gerhart	Paul J. Pitner	Monterey Revival		C	
1141 ARDEN RD	1948	Burton A. Schutt	Kenneth P. Schmidt	Kenneth P. Schmidt	International/Modern Style		NC	
1144 ARDEN RD	1926			Everett Phipps Babcock	Spanish Colonial Revival		C	Original permit missing
855 ROSALIND RD	1926	Everett Phipps Babcock	J.J. Brintnall	Everett Phipps Babcock	French Eclectic		C	Designated landmark