

PARKING PLAN

Las Encinas Hospital

Master Development Plan Amendment

SITE DATA

A- TOTAL PROPERTY AREA :	1,007,767
B- TOTAL BUILDING AREA :	524,482
C- TOTAL PARKING & VEHICULAR AREA :	252,415
D- TOTAL LANDSCAPE AREA :	230,870
LANDSCAPE AREA = D = A - (B + C)	
TOTAL LANDSCAPE AREA = 22.90% OF PROPERTY AREA.	

ADDITIONAL PARKING SPACE	
PARKING AREA 1:	103
PARKING AREA 2:	7
PARKING AREA 3:	5
PARKING AREA 4:	90
PARKING AREA 5:	14
RESIDENTIAL (1 PER UNIT):	28
TOTAL NEW PARKING:	247
TOTAL EXISTING PARKING:	293
TOTAL ON SITE PARKING:	540

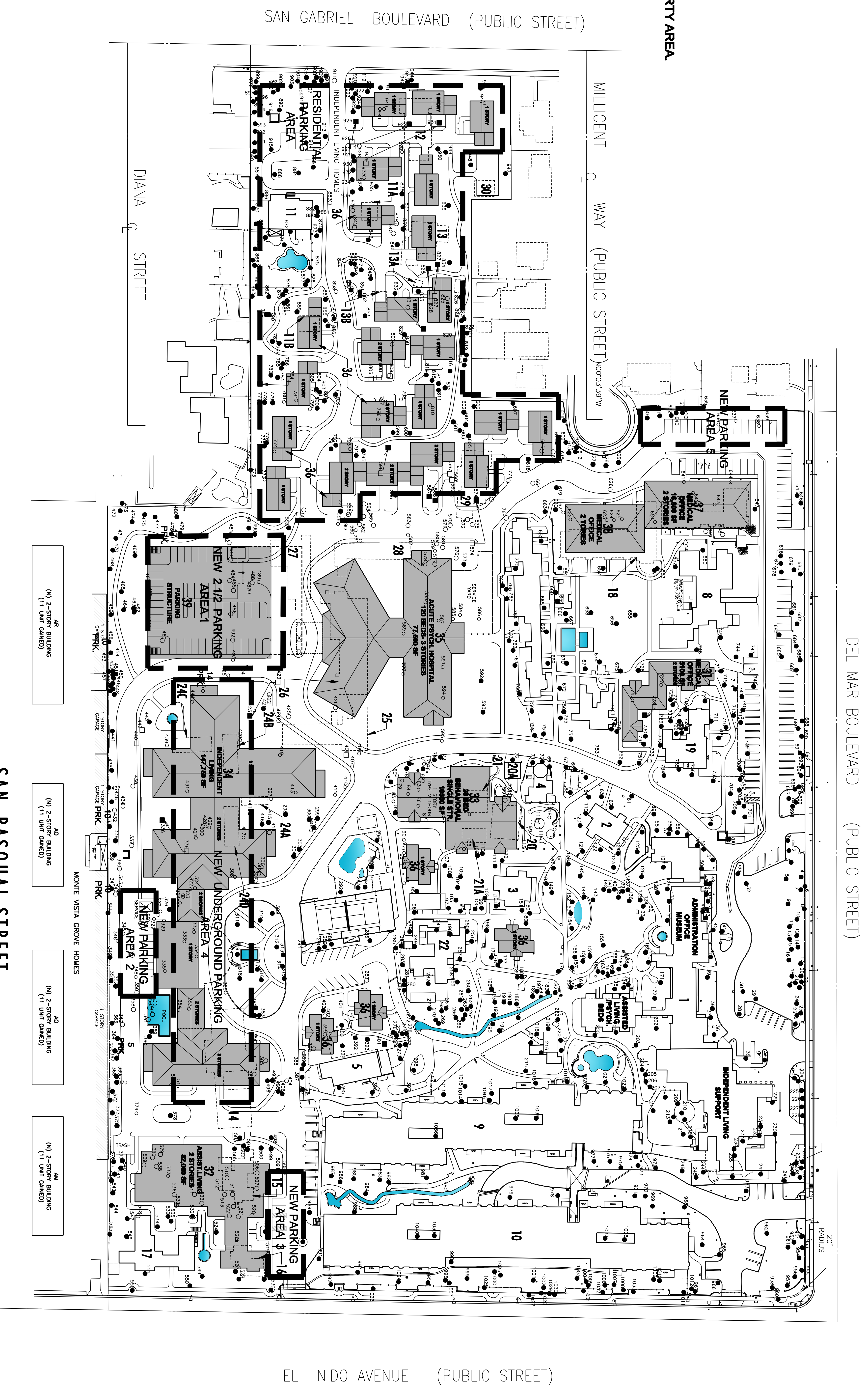

1 PARKING PLAN

1" = 120'-0"



MORSE - BOURREAU ARCHITECTS
 10914 Harwin Boulevard
 Houston, Texas 77036
 Tel: 281.416.4600
 Fax: 281.416.4601
 www.morse-bourreau.com

DATE: 10/30/08
 PROJECT NUMBER: 32-07
 SHEET NO.: 9 OF 22
 PROJECT ADDRESS: LAS ENCINAS HOSPITAL, 2900 EAST DEL MAR BLVD., PASADENA, CA 91107