

# SITE PLAN

January 17, 2008  
 Las Encinas Hospital / Acute Care Development (S-07)  
 MDC151204-0400000001-0000000001-SHA1

EGS08-18 - Acute Building (as located in 1979 ADP)  
 F = Existing Building  
 ER = Existing Building to Remain  
 R = Building to be Replaced

Tag	Building	Category	Structure	Use	Condition	Notes	1979	2008	Notes
1	Acute Building	F	47,557	Administration	Administration	Administration	ER	ER	20,520
2	Acute Building	F	1,633	Medical Office	Medical Office	Medical Office	ER	ER	20 Bed
3	Acute Building	F	1,629	Medical Office	Medical Office	Medical Office	ER	ER	20 Bed
4	Acute Building	F	1,340	Medical Office	Medical Office	Medical Office	ER	ER	20 Bed
5	Acute Building	F	2,125	Medical Office	Medical Office	Medical Office	ER	ER	20 Bed
6	Acute Building	F	1,777	Medical Office	Medical Office	Medical Office	ER	ER	20 Bed
7	Acute Building	F	5,560	Medical Office	Medical Office	Medical Office	ER	ER	20 Bed
8	Acute Building	F	5,372	Medical Office	Medical Office	Medical Office	ER	ER	20 Bed
9	Acute Building	F	42,800	Medical Office	Medical Office	Medical Office	ER	ER	20 Bed
10	Acute Building	F	51,477	Medical Office	Medical Office	Medical Office	ER	ER	20 Bed
11	Acute Building	F	4,100	Medical Office	Medical Office	Medical Office	ER	ER	20 Bed
12	Acute Building	F	255	Medical Office	Medical Office	Medical Office	ER	ER	20 Bed
13	Acute Building	F	2,624	Medical Office	Medical Office	Medical Office	ER	ER	20 Bed
14	Acute Building	F	1,715	Medical Office	Medical Office	Medical Office	ER	ER	20 Bed
15	Acute Building	F	720	Medical Office	Medical Office	Medical Office	ER	ER	20 Bed
16	Acute Building	F	400	Medical Office	Medical Office	Medical Office	ER	ER	20 Bed
17	Acute Building	F	4,000	Medical Office	Medical Office	Medical Office	ER	ER	20 Bed
18	Acute Building	F	4,000	Medical Office	Medical Office	Medical Office	ER	ER	20 Bed
19	Acute Building	F	4,000	Medical Office	Medical Office	Medical Office	ER	ER	20 Bed
20	Acute Building	F	4,000	Medical Office	Medical Office	Medical Office	ER	ER	20 Bed
21	Acute Building	F	4,000	Medical Office	Medical Office	Medical Office	ER	ER	20 Bed
22	Acute Building	F	4,000	Medical Office	Medical Office	Medical Office	ER	ER	20 Bed
23	Acute Building	F	4,000	Medical Office	Medical Office	Medical Office	ER	ER	20 Bed
24	Acute Building	F	4,000	Medical Office	Medical Office	Medical Office	ER	ER	20 Bed
25	Acute Building	F	4,000	Medical Office	Medical Office	Medical Office	ER	ER	20 Bed
26	Acute Building	F	4,000	Medical Office	Medical Office	Medical Office	ER	ER	20 Bed
27	Acute Building	F	4,000	Medical Office	Medical Office	Medical Office	ER	ER	20 Bed
28	Acute Building	F	4,000	Medical Office	Medical Office	Medical Office	ER	ER	20 Bed
29	Acute Building	F	4,000	Medical Office	Medical Office	Medical Office	ER	ER	20 Bed
30	Acute Building	F	4,000	Medical Office	Medical Office	Medical Office	ER	ER	20 Bed
31	Acute Building	F	4,000	Medical Office	Medical Office	Medical Office	ER	ER	20 Bed
32	Acute Building	F	4,000	Medical Office	Medical Office	Medical Office	ER	ER	20 Bed
33	Acute Building	F	4,000	Medical Office	Medical Office	Medical Office	ER	ER	20 Bed
34	Acute Building	F	4,000	Medical Office	Medical Office	Medical Office	ER	ER	20 Bed
35	Acute Building	F	4,000	Medical Office	Medical Office	Medical Office	ER	ER	20 Bed
36	Acute Building	F	4,000	Medical Office	Medical Office	Medical Office	ER	ER	20 Bed
37	Acute Building	F	4,000	Medical Office	Medical Office	Medical Office	ER	ER	20 Bed
38	Acute Building	F	4,000	Medical Office	Medical Office	Medical Office	ER	ER	20 Bed
39	Acute Building	F	4,000	Medical Office	Medical Office	Medical Office	ER	ER	20 Bed

# Las Encinas Hospital

## Master Development Plan Amendment

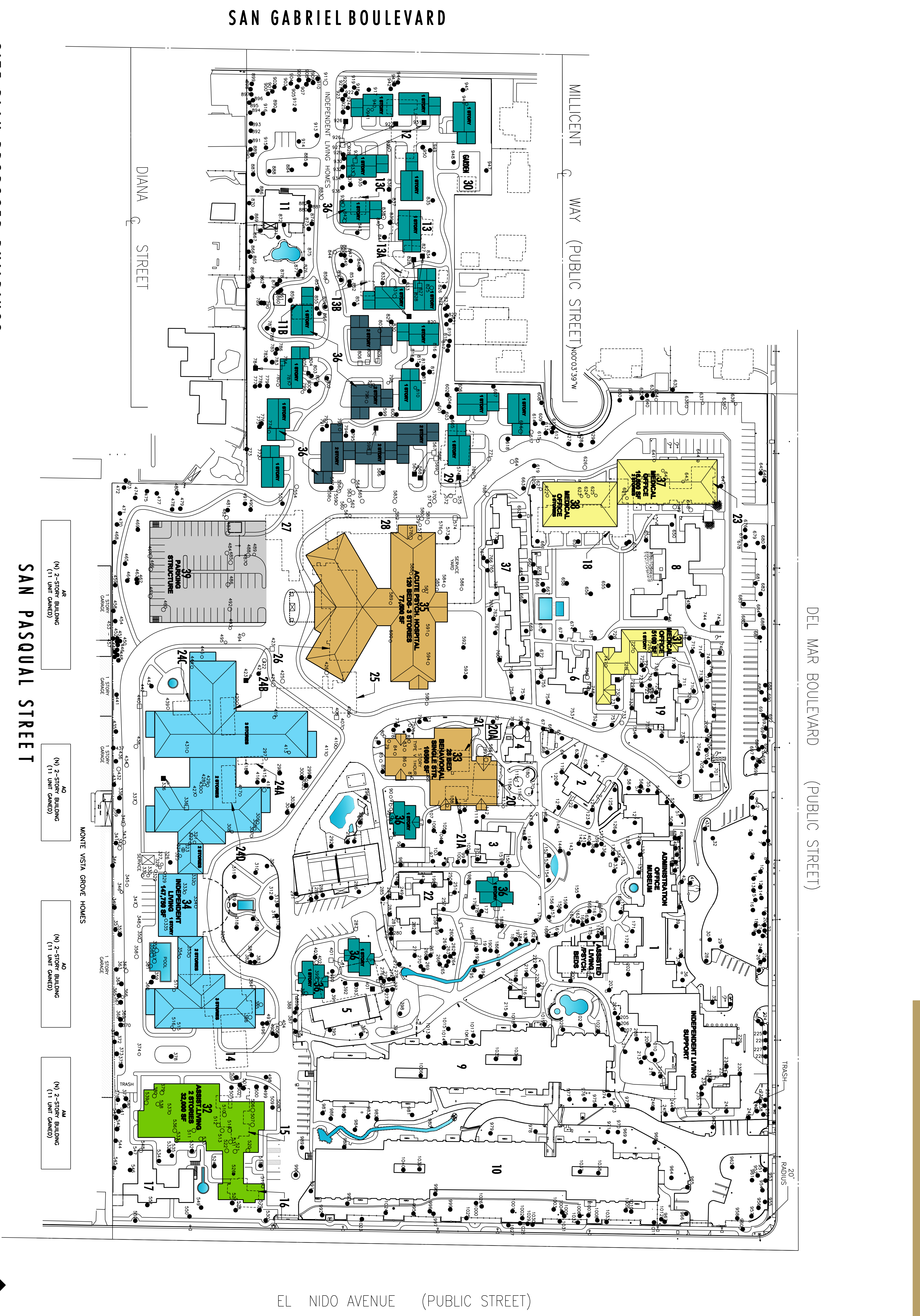

1 SITE PLAN: PROPOSED BUILDINGS  
 1" = 120'-0"

(N) 2-STORY BUILDING  
 (11 UNIT DAMAGED)

(N) 2-STORY BUILDING  
 (11 UNIT DAMAGED)

(N) 2-STORY BUILDING  
 (11 UNIT DAMAGED)

**M-BR**  
 MORSE - BOUDREAU ARCHITECTS  
 1921 Newport Boulevard  
 Costa Mesa, CA 92627  
 TEL: 714.441.4800  
 FAX: 714.441.5802

DATE: 10/30/08  
 PROJECT NUMBER: 32-07  
 SHEET NO: 7 OF 22  
 PROJECT ADDRESS: LAS ENCINAS HOSPITAL, 2900 EAST DEL MAR BLVD., PASADENA, CA 91107