

# Las Encinas Hospital Master Development Plan Amendment

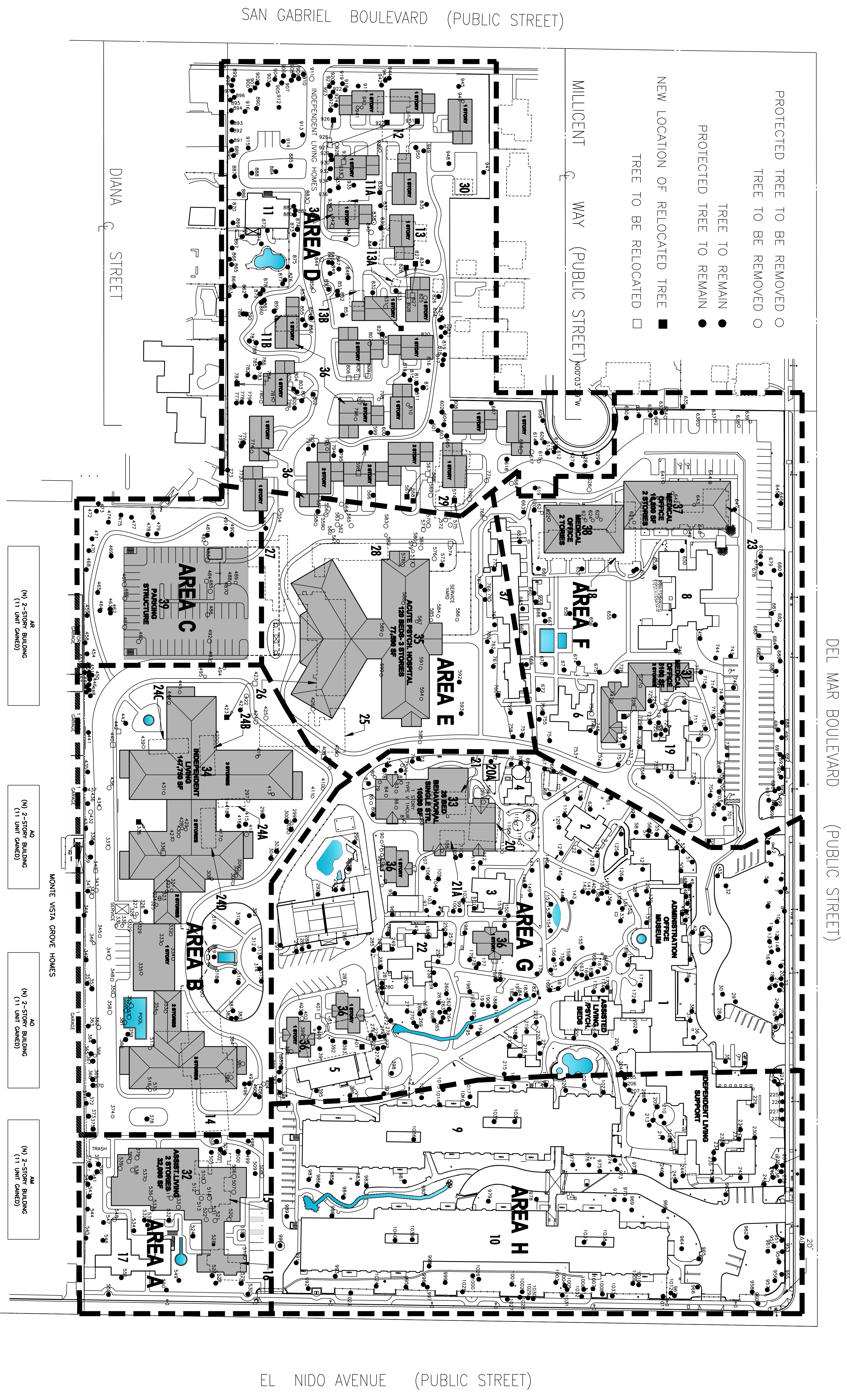

SAN GABRIEL BOULEVARD (PUBLIC STREET)

DEL MAR BOULEVARD (PUBLIC STREET)

EL NIDO AVENUE (PUBLIC STREET)

## 1 TREE PARCEL PLAN-REFERENCE FOR TREE ANALYSIS

1" = 120'-0"

35 (N) 2-STORY BUILDING (11 UNIT GAINED)

40 (N) 2-STORY BUILDING (11 UNIT GAINED)

40 (N) 2-STORY BUILDING (11 UNIT GAINED)

44 (N) 2-STORY BUILDING (11 UNIT GAINED)

DATE: 10/30/08

PROJECT NUMBER: 32-07

SHEET NO.: 17 OF 22

PROJECT ADDRESS: LAS ENCINAS HOSPITAL, 2900 EAST DEL MAR BLVD., PASADENA, CA 91107



OSHA #554

MORSE - BOURREAU ARCHITECTS

1991 Newport Boulevard

Costa Mesa, CA 92627

TEL: 714.440.1500

FAX: 714.951.8812

WWW.MORSEBOURREAU.COM