

### Churches on Campus At A Glance

WCIU is a research university. As such, we develop and test theories in the field of International Development. In keeping with our approach of networking with organizations rather than hiring additional staff ourselves, we have attracted to our campus organizations that can field-test our theories within various constituencies.

As we mentioned earlier, most International Development is conducted by non-governmental organizations, which are religious in nature. These NGO's draw staff and financial resources from churches; so, WCIU has invited a number of churches to participate with us to test our concepts.

Each church has a unique ministry focus. These churches vary in size and methodology. Most of their meetings occur on Sundays when the campus is not utilized by the weekday staff and students. Parking is provided on campus parking lots.

Harvest Rock Church, which had met in our largest auditorium bought Ambassador Auditorium and no longer meets on our campus. However, they maintain their offices here. Consistent with our philosophy of networking with other organizations, we invited another church, Mosaic, to meet in Mott Auditorium.

#### **Headings in this section:**

- Abundant Life Community Church
- Lifeline International Christian Fellowship
- Mosaic Church
- church attendance chart
- site plan of church locations

### **Abundant Life Community Church**

ALCC is a charismatic reformed congregation committed to the team concept of establishing new churches internationally. This church with an attendance of about 200 adults and children is located in La-tourette Library. Its people use the Speer and Aylward parking lots. We are opening our tennis courts for Sunday parking for this church.

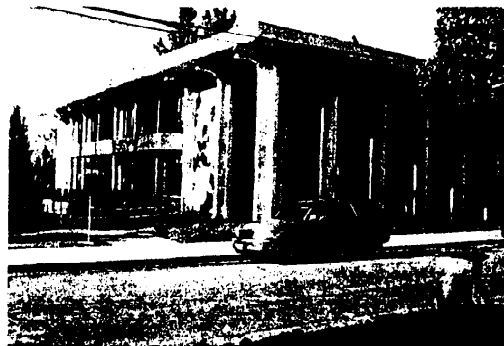

### **Lifeline International Christian Fellowship**

Lifeline met on this campus for many years and still maintains their offices here. They are temporarily meeting here on Sunday afternoons while they seek another location to be able to resume Sunday morning services. They conduct weekend classes to train their members to meet human and spiritual needs in other parts of the world.

### **Mosaic**

Mosaic Church is a church of over 1500, with a strong international commitment. Only part of their church meets on our campus. Currently they hold two services Sunday mornings in Mott Auditorium.



They park in the Townsend and Mott parking lots as well as the lot behind the U S Center for World Mission.

### Sunday Attendance & Projected Growth

Church	2003 Average		2005 Average		2008 Projection	
	People	Cars	People	Cars	People	Cars
Abundant Life Community Church	200	45	200	45	250	60
Harvest Rock Church	550	200			0	0
feline International Christian Fellowship (1)	90	25	50	15	0	0
Pasadena Evangelical Methodist Church	75	25			0	0
Mosaic (2)			650	350	1,700	750
Sunday Morning Church Totals	915	295	900	410	1,950	810

1 - Temporarily meeting Sunday afternoons while seeking a new location off-site for Sunday mo

2 - Mosaic will hold two services Sunday mornings until they have adequate parking or shuttle s

Campus lots plus the USCWM lot have parking for 409 cars.

Adjustments to current on-campus parking should net an additional 97 parking spaces.

The curbs bordering the campus can accommodate an additional 100 cars.

Parking spaces on or immediately adjacent to our campus total 606.

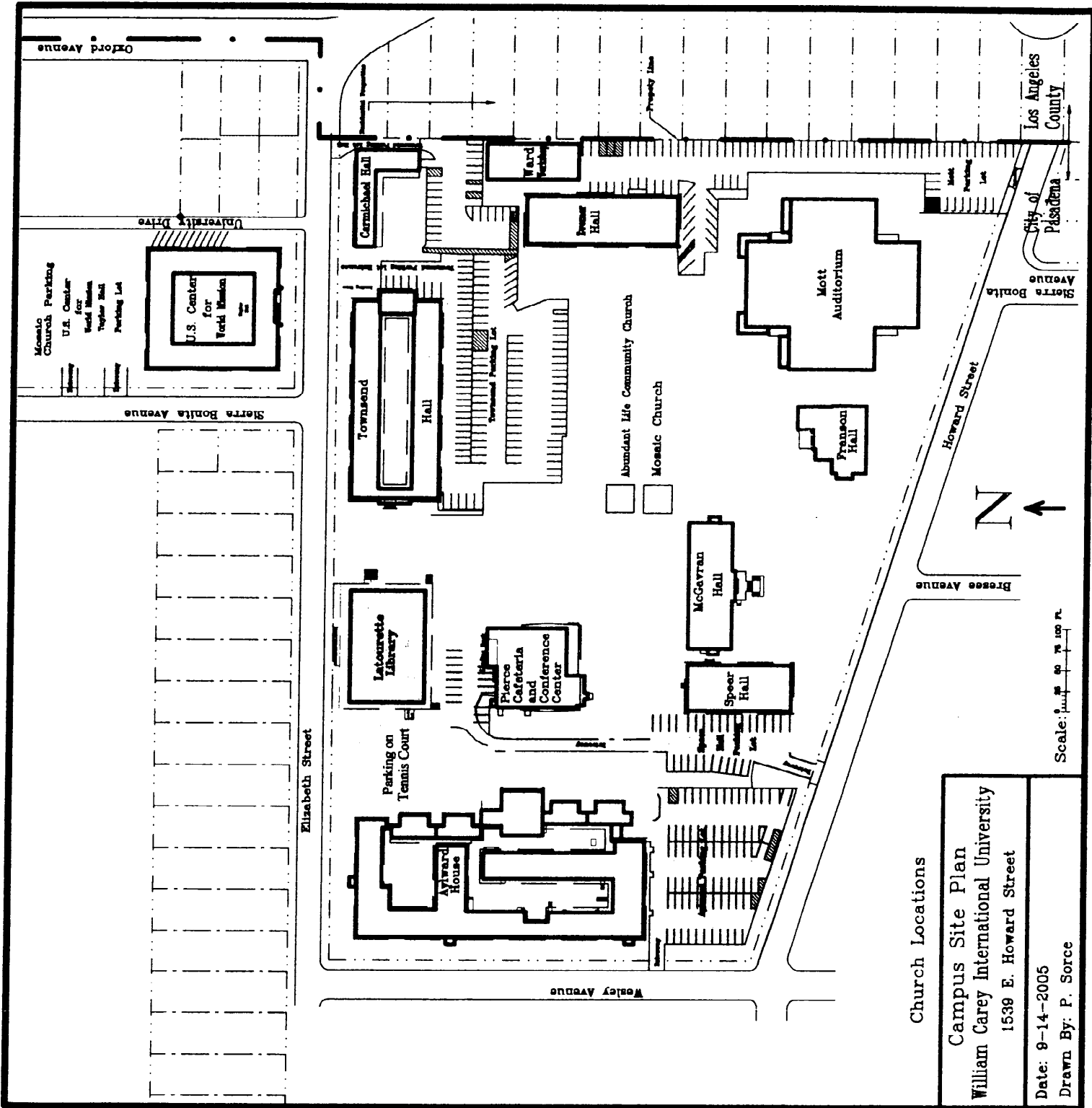

Church Locations

Campus Site Plan  
 William Carey International University  
 1539 E. Howard Street

Date: 9-14-2005  
 Drawn By: P. Sorce

**Attendance & Projected Growth**

Church	Average Sunday in 2003		Projected for 2008	
	Attendance	Cars Parked	Attendance	Cars Parked
Abundant Life Community Church	200	39	225	70
Harvest Rock Church	550	200		
Mosaic			1,500	500
Lifeline International Christian Fellowship	90	25		
Pasadena Evangelical Methodist Church	75	25		
Totals	915	289	1,725	570

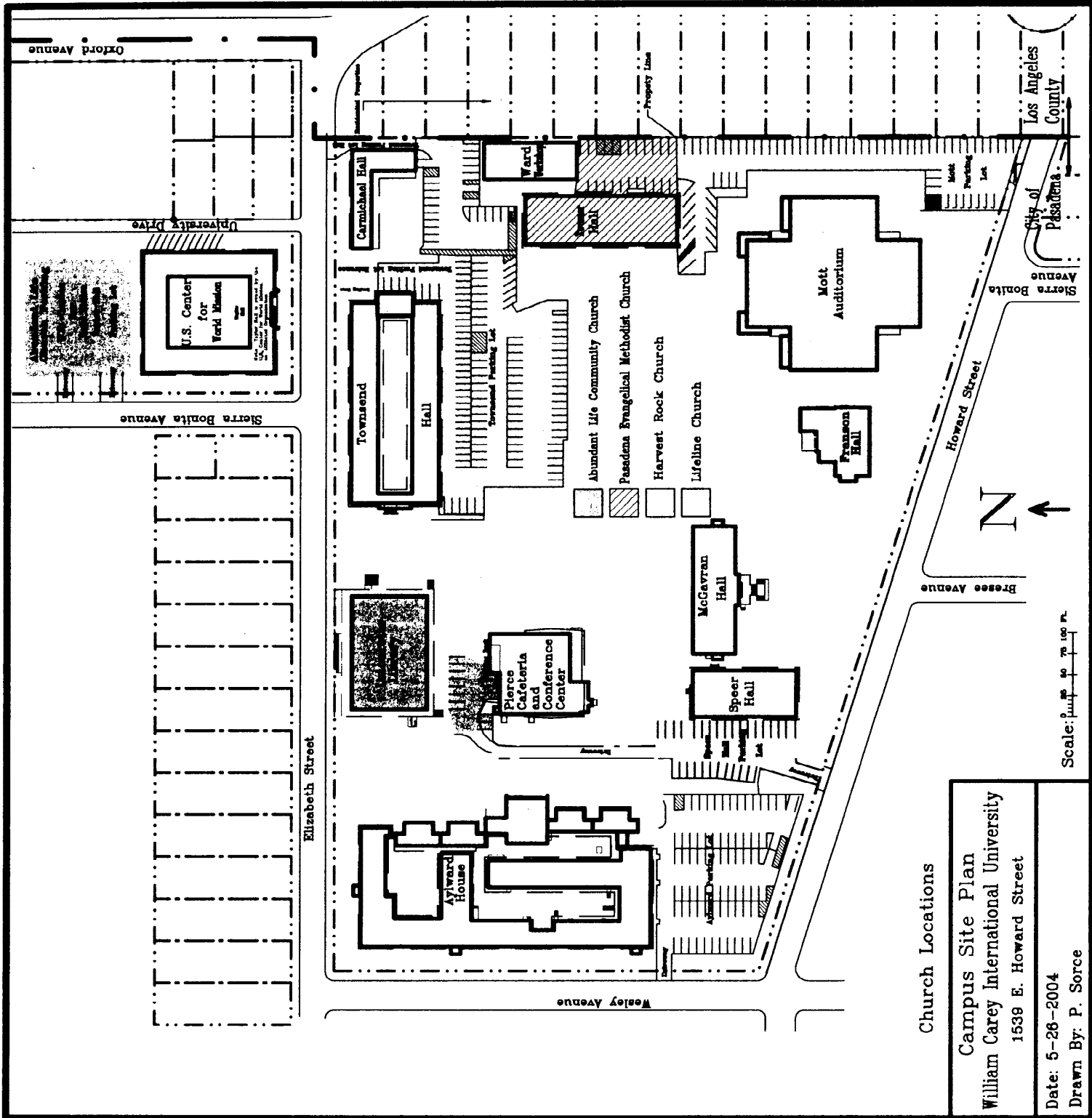

Church Locations

Campus Site Plan  
William Carey International University

1539 E. Howard Street

Date: 5-28-2004

Drawn By: P. Sorce

### Other Participating Organizations At A Glance

As was stated in the Operational Philosophy section, many of the functions of the university are out-sourced to other participating organizations on the campus. Most of these participating organizations have a limited focus. WCIU does not staff these organizations. Rather, we invite people and organizations that already have a focus for something in which we need their help.

From time-to-time, their needs and our needs change. Participating organizations come and go either at their request or ours. But, our philosophy remains constant – we deliberately out-source some of the functions of the university to other organizations.

Some of these participating organizations are focused on particular peoples of the world and they provide research and training opportunities for students. Others are in effect part of the International Student Program on campus. Some function as our placement department while also assisting graduates of other schools who wish to invest themselves fully in other cultures. We invite some organizations to participate with us in order to disseminate our ideas on international development to constituencies that we might not otherwise be able to reach.

We have our own publications department and some of the participating organizations also have publications focused on international development. Printing and photocopying needs are addressed both by WCIU directly and by participating organizations and so is housing for staff and students. We out-source audio/visual and travel services also.

#### **Headings in this section:**

- Ethnic Focus Organizations
- International Student Program
- Placement
- Marketing
- Business Development
- Publications
- Printing And Photocopying
- Audio/Visual
- Travel
- Housing
- Building Uses & Organization Locations

### Ethnic Focus Organizations

Some of these participating organizations are focused on particular peoples of the world and they provide research and training opportunities for students.

- **The Institute for Japanese Studies** does research on the Japanese peoples in the US and other countries where Japanese reside. The IJS disseminates information to churches, pastors, missionaries, and students.
- **Operation Ezekiel**, on the other hand, provides a focus on Israel and the Jewish people for WCIU students and other researchers. They educate local churches about Israel, the Jewish people, and the MiddleEast Arab/Israeli conflict, and, by the way, deplore the “conversion” of Jews into Christians. Specifically, they focus on Israeli Jews in greater LA.
- **Chinese Foundation Ministries** adds a vital dimension to the university since at this time the university does not yet have a department of Chinese studies. Its resources on China are available to all students both on and off campus.

### International Student Program

Some other participating organizations are in effect part of the International Student Program on campus.

- **Intercultural Missions Institute** trains Korean university students in English, US culture and international development. From classrooms to dormitory and cafeteria, their students are an integral part of the campus.

### Placement

Still other participating organizations function as our placement department while also assisting graduates of other schools who wish to invest themselves fully in other cultures.

- **Go Ye Fellowship**, on the other hand, provides a vehicle for those wishing to work abroad independently and helps them locate funding resources to supplement the lower salaries in developing countries.



### Marketing

We have invited some organizations to participate with us in order to disseminate our ideas on international development to constituencies that we might not otherwise be able to reach.

- **Christian Educators Association International** is a professional association, which provides unique training and resources to teachers throughout North America
  - CEAI provides WCIU with a channel of communication to grassroots elementary and secondary educators.
  - They find significant opportunities here for training and networking as well as the availability of equipment, services and facilities.
- The **Center for Anabaptist Leadership** serves Mennonite church leaders in Southern California.
  - They focus on empowering their local congregations to serve the immigrant world at their doorsteps.
  - The campus provides them with on-campus housing and dining facilities for their conferences in a location convenient to their constituency.
- **Unreached Nations** their focus is individuals and churches within the charismatic and pentecostal traditions.
  - They promote tools and programs developed at WCIU.
  - Their reasons for participating on the campus are:
    - to derive mutual encouragement and support;
    - to have accessibility to personnel and resources;
    - to gain credibility by association; and
    - to have exposure to people interested in serving the neediest peoples in the world.

### **Business Development**

One approach to International Development is to help third-world societies develop family businesses to support themselves and others within their culture.

- **International Interns** trains leaders in developing countries.
  - They help their people develop family businesses.
  - They network with other campus organizations, schools and churches and provide practicum opportunities for WCIU students.

### **Publications**

In addition to our own publications department, some of the participating organizations have publications focused on international development.

**Peridico Inter D** provides publications in Spanish for the North American Hispanic population. They communicate ideas and programs generated by WCIU to North American Latinos.

### **Printing And Photocopying**

Printing and photocopying needs are addressed both by WCIU directly and by participating organizations.

- Many campus organizations have small office copiers for routine, low volume photocopying.
- When they need to access better equipment and services, they can use WCIU's large, sophisticated self-service copiers or engage the services of off-set printing organizations on campus.
  - **Positive Press** handles small to medium size printing.
  - **Trinity Press** has the equipment to run large, complex, printing jobs.
- Both organizations are committed to providing convenient, low-cost printing to WCIU and other campus organizations, as well as other local organizations focused on various aspects of international development.

**Audio/Visual**

The audio/visual functions of the university are also out-sourced.

- **Frontier Media** provides and operates audio/visual equipment for meetings on campus.
- **Versatape** produces educational audio products and assists other participating organizations with their audio duplicating needs.

**Travel**

A focus on international development leads naturally into the need to fly to conferences and training sessions elsewhere both domestically as well as internationally.

**Travel International** offers the convenience of an on-campus travel agency.

**Housing**

WCIU directly handles most of the housing for staff and students (see Campus Housing section), but we do out-source some.

**Providence Homes** provides fully furnished apartments nearby for international development workers who plan to be in the area for a year or less and who work or study.

**Building Uses & Organization Locations**

Two charts follow showing buildings, organizational locations and uses as well as square footage.

**Location of Organizations**

Sorted by

Organization Building Level Use

Grouped by:

- WCIU Departments and Divisions
- Current Participating Organizations
- vacancies

**Use By Building**

Sorted by

Building Organization Level Use

### Audio/Visual

The audio/visual functions of the university are also out-sourced.

- **Frontier Media** provides and operates audio/visual equipment for meetings on campus.
- **Versatape** produces educational audio products and assists other participating organizations with their audio duplicating needs.

### Travel

A focus on international development leads naturally into the need to fly to conferences and training sessions elsewhere both domestically as well as internationally.

**Travel International** offers the convenience of an on-campus travel agency.

### Housing

WCIU directly handles most of the housing for staff and students (see Campus Housing section), but we do out-source some.

**Providence Homes** provides fully furnished apartments nearby for international development workers who plan to be in the area for a year or less and who work or study.

### Building Uses & Organization Locations

Two charts follow showing buildings, organizational locations and uses as well as square footage.

#### **Location of Organizations**

Sorted by

Organization Building Level Use

Grouped by:

- WCIU Corporate
- Large Participating Organizations
- Small Participating Organizations

#### **Use By Building**

Sorted by

Building Organization Level Use

# WCIU Master Plan Location of Organizations on Campus

Vla-1

<u>WEEKDAY OCCUPANT</u>	<u>BUILDING</u>	<u>LEVEL</u>	<u>ROOM</u>	<u>CATEGORY</u>	<u>SQ. FT</u>	<u>WEEKEND USE</u>
<u>Space Occupied by WCIU Departments and Divisions</u>						
WCIU	Franson	upper	U-3	storage	64	
WCIU	McGavran	lower	L-10	office	346	
WCIU	Mott	exterior	E-4	storage	129	
WCIU	Pierce	lower	L-4	storage	99	
WCIU	Pierce	lower	L-7	storage	188	
WCIU	Townsend	middle	M-03a	VIP guest suite	358	
WCIU	Ward	northwest		storage	298	
WCIU / George Mueller Academy	Zwemer	upper	U-01	classroom	1053	Mosaic Church
WCIU / Global Year of Insight	Latourette	middle		classroom	1512	
WCIU / Judson International School	Carmichael	main	M-1	5 classrooms	3168	
WCIU / Judson International School	Carmichael	lower	L-3	storage	364	
WCIU / Judson International School	Zwemer	lower	L-01	3 classrooms	1858	Mosaic Church
WCIU / Judson International School	Zwemer	lower	L-02a-c	offices	1028	
WCIU / Judson International School	Zwemer	lower	L-05b,c	storage	142	
WCIU Academic Affairs	Speer	upper		conference room	334	
WCIU Academic Affairs	Speer	upper		offices	2305	
WCIU Admissions & Records	Speer	lower		offices	778	
WCIU Archives	Franson	lower	L-2	storage	955	
WCIU Artifacts	Latourette	middle		storage	252	
WCIU Artifacts	Townsend	middle	M-12a	office	210	
WCIU Business Affairs	Speer	lower		conference room	242	
WCIU Business Affairs	Speer	lower		offices	2630	
WCIU Campus Information	Townsend	middle	M-13	office	311	
WCIU Custodial Supplies	Townsend	lower		storage	380	
WCIU Executive Offices	Speer	upper		offices	764	
WCIU Food Service	Pierce	upper	U-D	dining rooms	4761	
WCIU Food Service	Pierce	upper	U-2	food storage	440	
WCIU Food Service	Pierce	lower	L-2	kitchen	277	
WCIU Food Service	Pierce	upper	U-K	kitchen	1882	
WCIU Food Service	Pierce	upper	U-1	lobby	93	
WCIU Food Service	Pierce	upper	U-1a	office	92	
WCIU Food Service	Pierce	lower	L-1	snack shop	1097	
WCIU Grounds	Townsend	lower		shop	380	
WCIU Information Technology	Townsend	middle	M-05	offices	442	
WCIU Information Technology	Townsend	lower		offices & shop	600	
WCIU Intercultural Communications	Speer	lower		office	273	
WCIU Latourette Library	Latourette	upper		library	10750	
WCIU Latourette Library	Latourette	lower	L-06	library storage	692	
WCIU Maintenance	Townsend	lower		shops	3621	
WCIU Publications	Speer	upper		offices	574	
WCIU Reception	Speer	lower		office	110	
WCIU Services	McGavran	middle	M-09	copy room	90	

# WCIU Master Plan Location of Organizations on Campus

Vla-2

<u>WEEKDAY OCCUPANT</u>	<u>BUILDING</u>	<u>LEVEL</u>	<u>ROOM</u>	<u>CATEGORY</u>	<u>SQ. FT</u>	<u>WEEKEND USE</u>
<u>Space Occupied by Current Participating Organizations</u>						
ALCC (Abundant Life Comm. Church	Latourette	lower	L-01-05	offices	2005	
ALCC	Latourette	middle		auditorium	3416	ALCC
ALCC	Latourette	middle		church library	126	ALCC
ALCC	Latourette	middle		classrooms	2631	ALCC
ALCC	Latourette	middle		kitchen	245	ALCC
campus community art studio	Zwemer	lower	L-06	1 classroom	978	Mosaic Church
Center for Anabaptist Leadership	Townsend	upper	U-02	offices	616	
Chinese Foundation Ministries	Townsend	middle	M-10a	office	218	
Christian Educators Association Int'l.	Townsend	middle	M-07-08	offices	2019	
Emmanuel Bible College	Franson	lower	L-3	library	533	
Frontier Media	Franson	upper	U-2	editing studio	230	
Frontiers	Townsend	upper	U-04a	office	223	
Global Diaspora	Townsend	upper	U-03d	office	222	
Global Spectrum	Townsend	middle	M-09c	office	224	
Go Ye Fellowship	Townsend	upper	U-05	offices	1106	
Harvest International Ministries	Zwemer	upper	U-10&11	office	1143	
Harvest Rock /Hollywood	Townsend	upper	U-11	offices	1105	
Harvest Rock Church	Mott	exterior		storage	699	
Harvest Rock Church	Zwemer	upper	U-05	conference room	1127	Mosaic Church
Harvest Rock Church	Zwemer	lower		office	1566	
Harvest Rock Church	Zwemer	upper	U-04	offices	1638	
Harvest Rock Church	Zwemer	upper		storage	388	
Highland Community Church	Townsend	upper	U-03b	office	204	
Hollywood Prayer Digest	Townsend	middle	M-05c	office	220	
Institute of Japanese Studies	Townsend	middle	M-10d	office	222	
Intercultural Mission Institute	Townsend	middle	M-11c&d	offices	411	
International Interns	Latourette	lower	L-08	office	1118	
Japan Helpline	Townsend	middle	M-12b	office	207	
Julienne Bowman Office Services	Townsend	middle	M-09a	office	219	
Lifeline International Fellowship	Townsend	upper	U-01	offices	1054	
MIMEistry	Franson	lower	L-4&5	classrooms	1417	
miscellaneous	Ward	east side		storage	2375	
Mission Strategy Agency	Townsend	upper	U-03a	office	223	
Mosaic Architects	McGavran	lower	L-12b	conference room	190	
Mosaic Architects	McGavran	lower	L-13	offices	701	
Mosaic Church	Mott	exterior	E-3	kitchen	130	
Mosaic Church	Mott	lower	L-S	storage	1445	
Operation Ezekiel	Townsend	upper	U-04d	office	221	
Pasadena International House of Praye	Townsend	upper	U-03c	office	219	
Paul Mission USA	Townsend	upper	U-04b	office	220	
Periodico Inter D	Townsend	middle	M-10c	office	219	
Positive Press	Townsend	lower		shop	1207	
Providence Mission Homes	Townsend	upper	U-04c	office	220	
Reclaiming the Valley	Townsend	middle	M-09b,d	office	660	
Servant Partners	Townsend	upper	U-12	office	431	
Travel International	Townsend	middle	M-12c	office	208	
Trinity Press	Ward	west side		shop	2375	
Versatape	Townsend	middle	M-01-02	offices & workrooms	1919	
WBT - Chinese Mobilization	Townsend	middle	M-11a&b	offices	431	
WBT - Korean Relations	Townsend	middle	M-12d	office	204	

<b>WCIU Master Plan</b>	<b>Location of Organizations on Campus</b>					
<u>WEEKDAY OCCUPANT</u>	<u>BUILDING</u>	<u>LEVEL</u>	<u>ROOM</u>	<u>CATEGORY</u>	<u>SQ. FT</u>	<u>WEEKEND USE</u>
On-Campus Housing	Townsend	middle	M-03	residence	739	
On-Campus Housing	Townsend	middle	M-06	residence	1240	
On-Campus Housing	Townsend	upper	U-13	residence	984	
occasional conferences	Franson	upper	U-4	auditorium	3027	Mosaic Church
occasional conferences	Mott	main floor		auditorium	28967	Mosaic Church
occasional conferences	Pierce	lower	L-3	conference room	4015	
occasional conferences	Pierce	lower	L-5&6	meeting rooms	401	
occasional conferences	Townsend	middle		conference room	707	
occasional conferences	Zwemer	lower	L-07	lecture hall	1251	Mosaic Church
occasional conferences	Zwemer	upper	U-07	lecture hall	1785	Mosaic Church
conference housing	Townsend	upper	U-07-10	16 guest rooms	4236	
common	Franson	upper		lobby	478	
common	Latourette	middle		lobbies	821	AI.CC

### Space Available for Future Participating Organizations

vacant	Franson	lower	L-1	classroom	197	Mosaic Church
vacant	Franson	lower	L-7	classroom	238	Mosaic Church
vacant	Franson	lower	L-8	classroom	329	Mosaic Church
vacant	Franson	lower	L-9	classroom	386	Mosaic Church
vacant	Franson	upper	U-1	classroom	526	
vacant	Franson	lower	L-3a-d	storage	128	
vacant	Latourette	lower		8 offices	3710	
vacant	McGavran	lower		10 offices	3648	
vacant	McGavran	middle		11 offices	5031	
vacant	McGavran	upper		12 offices	5265	
vacant	Mott	lower	L-1	classroom	469	Mosaic Church
vacant	Mott	lower	L-2	classroom	470	Mosaic Church
vacant	Mott	lower	L-3	classroom	470	Mosaic Church
vacant	Mott	lower	L-4	classroom	475	Mosaic Church
vacant	Mott	upper	U-1	classroom	361	Mosaic Church
vacant	Mott	upper	U-2	classroom	468	Mosaic Church
vacant	Mott	upper	U-3	classroom	356	Mosaic Church
vacant	Mott	lower	L-5	storage	484	
vacant	Mott	upper	U-S1	storage	74	
vacant	Mott	upper	U-S2	storage	1200	
vacant	Townsend	upper		6 offices	1540	
vacant	Townsend	middle		7 offices	1765	
vacant	Zwemer	lower	L-08	classroom	503	
vacant	Zwemer	upper	U-02	office	659	
vacant	Zwemer	lower	L-08a	storage	181	

# WCIU Master Plan

# Building Uses

V1b-1

<u>BUILDING</u>	<u>WEEKDAY OCCUPANT</u>	<u>LEVEL</u>	<u>ROOM</u>	<u>CATEGORY</u>	<u>SQ. FT</u>	<u>WEEKEND USE</u>
<b><u>Primarily Classroom Buildings</u></b>						
Carmichael	WCIU / Judson International School			storage	364	
Carmichael	WCIU / Judson International School			5 classrooms	3168	
Franson	vacant	lower	L-1	classroom	197	Mosaic Church
Franson	WCIU Archives	lower	L-2	storage	955	
Franson	Emmanuel Bible College	lower	L-3	library	533	
Franson	vacant	lower	L-3a-d	storage	128	
Franson	MIMEistry	lower	L-4&5	classrooms	1417	
Franson	vacant	lower	L-7	classroom	238	Mosaic Church
Franson	vacant	lower	L-8	classroom	329	Mosaic Church
Franson	vacant	lower	L-9	classroom	386	Mosaic Church
Franson	vacant	upper	U-1	classroom	526	
Franson	Frontier Media	upper	U-2	editing studio	230	
Franson	WCIU	upper	U-3	storage	64	
Franson	occasional conferences	upper	U-4	auditorium	3027	Mosaic Church
Franson	common	upper		lobby	478	
Zwemer	WCIU / Judson International School	lower	L-01	3 classrooms	1858	Mosaic Church
Zwemer	WCIU / Judson International School	lower	L-02a-e	offices	1028	
Zwemer	WCIU / Judson International School	lower	L-05b,c	storage	142	
Zwemer	campus community art studio	lower	L-06	1 classroom	978	Mosaic Church
Zwemer	occasional conferences	lower	L-07	lecture hall	1251	Mosaic Church
Zwemer	vacant	lower	L-08	classroom	503	
Zwemer	vacant	lower	L-08a	storage	181	
Zwemer	Harvest Rock Church	lower		office	1566	
Zwemer	WCIU / George Mueller Academy	upper	U-01	classroom	1053	Mosaic Church
Zwemer	vacant	upper	U-02	office	659	
Zwemer	Harvest Rock Church	upper	U-04	offices	1638	
Zwemer	Harvest Rock Church	upper	U-05	conference room	1127	Mosaic Church
Zwemer	occasional conferences	upper	U-07	lecture hall	1785	Mosaic Church
Zwemer	Harvest International Ministries	upper	U-10&11	office	1143	
Zwemer	Harvest Rock Church	upper		storage	388	
<b><u>Primarily Office Buildings</u></b>						
McGavran	WCIU	lower	L-10	office	346	
McGavran	Mosaic Architects	lower	L-12	conference room	190	
McGavran	Mosaic Architects	lower	L-13	offices	701	
McGavran	vacant	lower		10 offices	3648	
McGavran	WCIU Services	middle	M-09	copy room	90	
McGavran	vacant	middle		11 offices	5031	
McGavran	vacant	upper		12 offices	5265	
Speer	WCIU Admissions & Records	lower		offices	778	
Speer	WCIU Business Affairs	lower		conference room	242	
Speer	WCIU Business Affairs	lower		offices	2630	
Speer	WCIU Intercultural Communications	lower		office	273	
Speer	WCIU Reception	lower		office	110	
Speer	WCIU Academic Affairs	upper		conference room	334	
Speer	WCIU Academic Affairs	upper		offices	2305	
Speer	WCIU Executive Offices	upper		offices	764	
Speer	WCIU Publications	upper		offices	574	



# WCIU Master Plan

# Building Uses

VIb-2

<u>BUILDING</u>	<u>WEEKDAY OCCUPANT</u>	<u>LEVEL</u>	<u>ROOM</u>	<u>CATEGORY</u>	<u>SQ. FT</u>	<u>WEEKEND USE</u>
Townsend	WCIU Custodial Supplies	lower		storage	380	
Townsend	WCIU Grounds	lower		shop	380	
Townsend	WCIU Information Technology	lower		offices & shop	600	
Townsend	WCIU Maintenance	lower		shops	3621	
Townsend	Positive Press	lower		shop	1207	
Townsend	Versatape	middle	M-01-02	offices & workrooms	1919	
Townsend	On-Campus Housing	middle	M-03	residence	739	
Townsend	WCIU	middle	M-03a	VIP guest suite	358	
Townsend	WCIU Information Technology	middle	M-05	offices	442	
Townsend	Hollywood Prayer Digest	middle	M-05c	office	220	
Townsend	On-Campus Housing	middle	M-06	residence	1240	
Townsend	Christian Educators Association Int'l.	middle	M-07-08	offices	2019	
Townsend	Julienne Bowman Office Services	middle	M-09a	office	219	
Townsend	Reclaiming the Valley	middle	M-09b,d	office	660	
Townsend	Global Spectrum	middle	M-09c	office	224	
Townsend	Chinese Foundation Ministries	middle	M-10a	office	218	
Townsend	Periodico Inter D	middle	M-10c	office	219	
Townsend	Institute of Japanese Studies	middle	M-10d	office	222	
Townsend	WBT - Chinese Mobilization	middle	M-11a&b	offices	431	
Townsend	Intercultural Mission Institute	middle	M-11c&d	offices	411	
Townsend	WCIU Artifacts	middle	M-12a	office	210	
Townsend	Japan Helpline	middle	M-12b	office	207	
Townsend	Travel International	middle	M-12c	office	208	
Townsend	WBT - Korean Relations	middle	M-12d	office	204	
Townsend	WCIU Campus Information	middle	M-13	office	311	
Townsend	occasional conferences	middle		conference room	707	
Townsend	vacant	middle		7 offices	1765	
Townsend	Lifeline International Fellowship	upper	U-01	offices	1054	
Townsend	Center for Anabaptist Leadership	upper	U-02	offices	616	
Townsend	Mission Strategy Agency	upper	U-03a	office	223	
Townsend	Highland Community Church	upper	U-03b	office	204	
Townsend	Pasadena International House of Praye	upper	U-03c	office	219	
Townsend	Global Diaspora	upper	U-03d	office	222	
Townsend	Frontiers	upper	U-04a	office	223	
Townsend	Paul Mission USA	upper	U-04b	office	220	
Townsend	Providence Mission Homes	upper	U-04c	office	220	
Townsend	Operation Ezekiel	upper	U-04d	office	221	
Townsend	Go Ye Fellowship	upper	U-05	offices	1106	
Townsend	conference housing	upper	U-07-10	16 guest rooms	4236	
Townsend	Harvest Rock /Hollywood	upper	U-11	offices	1105	
Townsend	Servant Partners	upper	U-12	office	431	
Townsend	On-Campus Housing	upper	U-13	residence	984	
Townsend	vacant	upper		6 offices	1540	

# WCIU Master Plan

# Building Uses

VIb-3

<u>BUILDING</u>	<u>WEEKDAY OCCUPANT</u>	<u>LEVEL</u>	<u>ROOM</u>	<u>CATEGORY</u>	<u>SQ. FT</u>	<u>WEEKEND USE</u>
<b>Other Buildings</b>						
Latourette	ALCC (Abundant Life Comm. Church	lower	L-01-05	offices	2005	
Latourette	WCIU Latourette Library	lower	L-06	library storage	692	
Latourette	International Interns	lower	L-08	office	1118	
Latourette	vacant	lower		8 offices	3710	
Latourette	WCIU / Global Year of Insight	middle		classroom	1512	
Latourette	WCIU Artifacts	middle		storage	252	
Latourette	ALCC	middle		auditorium	3416	ALCC
Latourette	ALCC	middle		church library	126	ALCC
Latourette	ALCC	middle		classrooms	2631	ALCC
Latourette	ALCC	middle		kitchen	245	ALCC
Latourette	common	middle		lobbies	821	ALCC
Latourette	WCIU Latourette Library	upper		library	10750	
Mott	Mosaic Church	exterior	E-3	kitchen	130	
Mott	WCIU	exterior	E-4	storage	129	
Mott	Harvest Rock Church	exterior		storage	699	
Mott	vacant	lower	L-1	classroom	469	Mosaic Church
Mott	vacant	lower	L-2	classroom	470	Mosaic Church
Mott	vacant	lower	L-3	classroom	470	Mosaic Church
Mott	vacant	lower	L-4	classroom	475	Mosaic Church
Mott	vacant	lower	L-5	storage	484	
Mott	Mosaic Church	lower	L-S	storage	1445	
Mott	occasional conferences	main floor		auditorium	28967	Mosaic Church
Mott	vacant	upper	U-1	classroom	361	Mosaic Church
Mott	vacant	upper	U-2	classroom	468	Mosaic Church
Mott	vacant	upper	U-3	classroom	356	Mosaic Church
Mott	vacant	upper	U-S1	storage	74	
Mott	vacant	upper	U-S2	storage	1200	
Pierce	WCIU Food Service	lower	L-1	snack shop	1097	
Pierce	WCIU Food Service	lower	L-2	kitchen	277	
Pierce	occasional conferences	lower	L-3	conference room	4015	
Pierce	WCIU	lower	L-4	storage	99	
Pierce	occasional conferences	lower	L-5&6	meeting rooms	401	
Pierce	WCIU	lower	L-7	storage	188	
Pierce	WCIU Food Service	upper	U-1	lobby	93	
Pierce	WCIU Food Service	upper	U-1a	office	92	
Pierce	WCIU Food Service	upper	U-2	food storage	440	
Pierce	WCIU Food Service	upper	U-D	dining rooms	4761	
Pierce	WCIU Food Service	upper	U-K	kitchen	1882	
Ward	miscellaneous	east side		storage	2375	
Ward	Trinity Press	west side		shop	2375	